

# REAR LOADER

# **MK2** *Series Minipac*

ORDERS FARID : **VA00693**

PUNCHING N° 0042 / 00390

MANUFACTURING YEAR: 2010



Farid Industrie spa  
ITALY



COMPANY  
WITH QUALITY SYSTEM  
CERTIFIED BY DNV  
**ISO 9001**

| <u>DENOMINAZIONE - NAME</u>                                   | <u>FILE</u>     | <u>INDICE-INDEX<br/>TAV.</u> |
|---|-----------------|------------------------------|
| <b><u>RICHIESTA RICAMBI<br/>SPARE PARTS REQUEST</u></b>       |                 |                              |
| <b><u>CARPENTERIA / CARPENTRY</u></b>                         |                 |                              |
| VOLTACONTENITORI<br>BIN LIFT                                  | MK2-CA01-REV-00 | T1                           |
|   | MK2-CA01-REV-01 | T1A                          |
|   | MK2-CA01-REV-01 | T1B                          |
|   | MK2-CA01-REV-02 | T1C                          |
| PROTEZIONE LATERALE IN PVC<br>LATERAL PROTECTION IN PVC       | MK2-CA01-REV-00 | T1D                          |
| PALA COMPATTAZIONE<br>PACKER PLATE                            | MK2-CA02-REV-03 | T2                           |
| SLITTA<br>SLIDE   | MK2-CA03-REV-01 | T3                           |
| TETTO FISSO<br>FIXED ROOF                                     | MK2-CA04-REV-01 | T4                           |
| PARATIA ESPULSIONE<br>EJECTION PLATE                          | MK2-CA05-REV-00 | T5                           |
| SPONDINA POSTERIORE<br>REAR FLAP                              | MK2-CA06-REV-01 | T6                           |
| SERBATOIO OLIO E ACCESSORI<br>OIL TANK AND ACCESSORIES        | MK2-CA07-REV-02 | T7                           |
| BARRA APRICOPERCHIO<br>COVER BIN BAR                          | MK2-CA08-REV-00 | T8                           |
| ACCESSORI E TARGHE ADESIVE<br>ACCESSORIES AND ADHESIVE LABELS | MK2-CA09-REV-01 | T9                           |
| ACCESSORI<br>ACCESSORIES                                      | MK2-CA09-REV-01 | T9A                          |

| <u>DENOMINAZIONE - NAME</u>                                | <u>FILE</u>     | <u>INDICE-INDEX<br/>TAV.</u> |
|--|-----------------|------------------------------|
| <b><u>IDRAULICA / HYDRAULIC</u></b>                        |                 |                              |
| CILINDRO PARATIA ESPULSIONE<br>CYLINDER FOR EJECTION PLATE | MK2-ID01-REV-00 | T11                          |
| CILINDRI PALA<br>CYLINDERS FOR PACKER PLATE                | MK2-ID02-REV-00 | T12                          |
| CILINDRI SLITTA<br>CYLINDER FOR SLIDE                      | MK2-ID03-REV-00 | T13                          |
| CILINDRI VOLTACONTENITORI<br>CYLINDERS FOR BIN LIFT        | MK2-ID04-REV-01 | T14                          |
| CILINDRO PETTINE<br>CYLINDER FOR MOVING FRAME              | MK2-ID05-REV-00 | T15                          |
| DISTRIBUTORE IDRAULICO COMP.<br>OIL DISTRIBUTOR            | MK2-ID06-REV-02 | T16                          |
| DISTRIBUTORE IDRAULICO SERVIZI.<br>OIL DISTRIBUTOR         | MK2-ID07-REV-00 | T17                          |
| GRUPPO VALVOLE CONTROPRESSIONE<br>SU DISTRIBUTORE SERVIZI  | MK2-ID07-REV-00 | T17B                         |
| <b><u>PNEUMATICA / PNEUMATIC</u></b>                       |                 |                              |
| COMPONENTI PNEUMATICI                                      | MK2-PN01-REV-06 | T19                          |

| <u>DENOMINAZIONE - NAME</u>  | <u>FILE</u>     | <u>INDICE-INDEX</u><br><u>TAV.</u> |
|--|-----------------|------------------------------------|
| <b><u>ELETTRICA / ELECTRIC</u></b>   |                 |                                    |
| IN CABINA-SINOTTICO<br>IN TO CABIN-SINOPTIC  | MK2-EL01-REV-01 | T20                                |
| SCATOLA ELETTRICA PRINCIPALE<br>ELECTRIC BOX   | MK2-EL02-REV-01 | T21                                |
| SENSORE PARATIA ESPULSIONE<br>SENSOR ON EJECTION PLATE   | MK2-EL03-REV-02 | T22A                               |
| SENSORE CHIUSURA PETTINE<br>SENSORS FOR LOCK MOVING FRAME  | MK2-EL04-REV-00 | T23                                |
| SENSORE SPONDINA<br>REAR FLAP – SENSOR   | MK2-EL05-REV-00 | T24                                |
| SENSORE CILINDRO SLITTA<br>SLIDE CILYNDER SENSOR   | MK2-EL07-REV-00 | T26                                |
| SENSORE CILINDRO PALA<br>PACKER PLATE – SENSORS  | MK2-EL08-REV-00 | T27                                |
| PULSANTIERA POSTERIORE DESTRA<br>CONTROL BOX SIDE RIGHT ( REAR )   | MK2-EL09-REV-03 | T28                                |
| PULSANTIERA ANTERIORE DESTRA<br>CONTROL BOX SIDE RIGHT ( FRONT )   | MK2-EL10-REV-01 | T29C                               |
| PULSANTIERA POSTERIORE SINISTRA<br>CONTROL BOX SIDE LEFT ( REAR )  | MK2-EL11-REV-01 | T30                                |
| ACCESSORI ELETTRICI<br>ELECTRIC ACCESSORIES  | MK2-EL12-REV-01 | T31                                |
| <b><u>SCHEMI - DIAGRAMS :</u></b>  |                 |                                    |
| SCHEMA IDRAULICO ( DIS. FARID N° 02110001574 - 03 )<br>HYDRAULIC DIAGRAM COMPLETE  |                 |                                    |
| SCHEMA IDRAULICO – VARIANTE CONTROPRESSIONE ( DIS. FARID N° 02110001662-00 )<br>HYDRAULIC DIAGRAM - VARIANT CONTROPRESSURE |                 |                                    |
| SCHEMA IDRAULICO PETTIINE SCORREVOLE ( DIS. FARID 02110001618-00 )<br>HYDRAULIC DIAGRAM – SLIDING MOVING FRAME             |                 |                                    |
| SCHEMA PNEUMATICO ( DIS. FARID N° 02120001131 )<br>PNEUMATIC DIAGRAM   |                 |                                    |
| SCHEMI ELETTRICI FARID - MK2 - ( EDIZIONE 24 APRILE 2007 )<br>ELECTRIC DIAGRAMS  |                 |                                    |

**\* ATTENTION \***

- 1) TO ORDER SPARE PARTS INDICATE:
  - A) EQUIPMENT PUNCHING N° OR VEHICLE CHASSIS N°
  - B) TABLE - N° (IN THE SPARE PARTS CATALOGUE) , CODE AND DESCRIPTION OF THE REQUESTED COMPONENT
  - C) QUANTITY REQUESTED
- 2) REFER TO OUR CUSTOMER SERVICE FOR ANY DOUBT OR EXPLANATION
- 3) DURING THE WARRANTY PERIOD FAULTY COMPONENTS WILL BE REPLACED ONLY AGAINST RETURN OF THOSE DAMAGED.

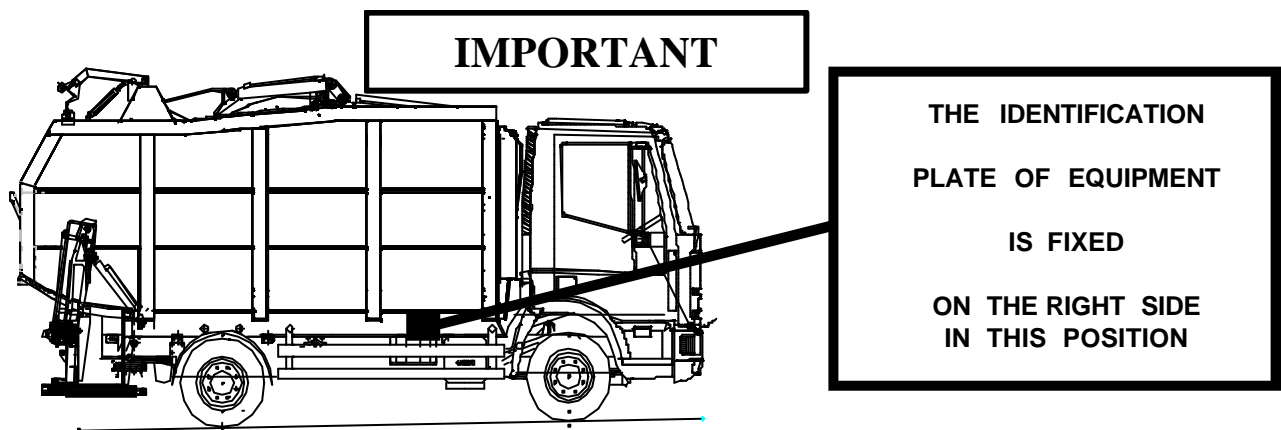

**PLEASE SEND THE SPARE PARTS ORDER TO:**

**FARID - MUNICIPAL VEHICLES LTD.** - Rudford Industrial Estate - Ford Arundel - West Sussex  
UNITED KINGDOM - BN 18 ODB - E-mail : fariduk@demon.co.ukt

Phone + 44 - 1903 - 732604

Fax + 44 - 1903 - 732605

**OR**

**FARID INDUSTRIE S.p.a.** - Strada Moncalieri 109 - Frazione Tetti Caglieri  
CAP 10048 - VINOVO ( TO ) - ITALY

Tel. + 39 - 011 - 9737406 - Fax +39 - 011-9737409

**CARPENTERIA**

**CARPENTRY**

**VOLTACONTENITORI**  
**BIN LIFT**
**VISTA GENERALE**  
**GENERAL VIEW**

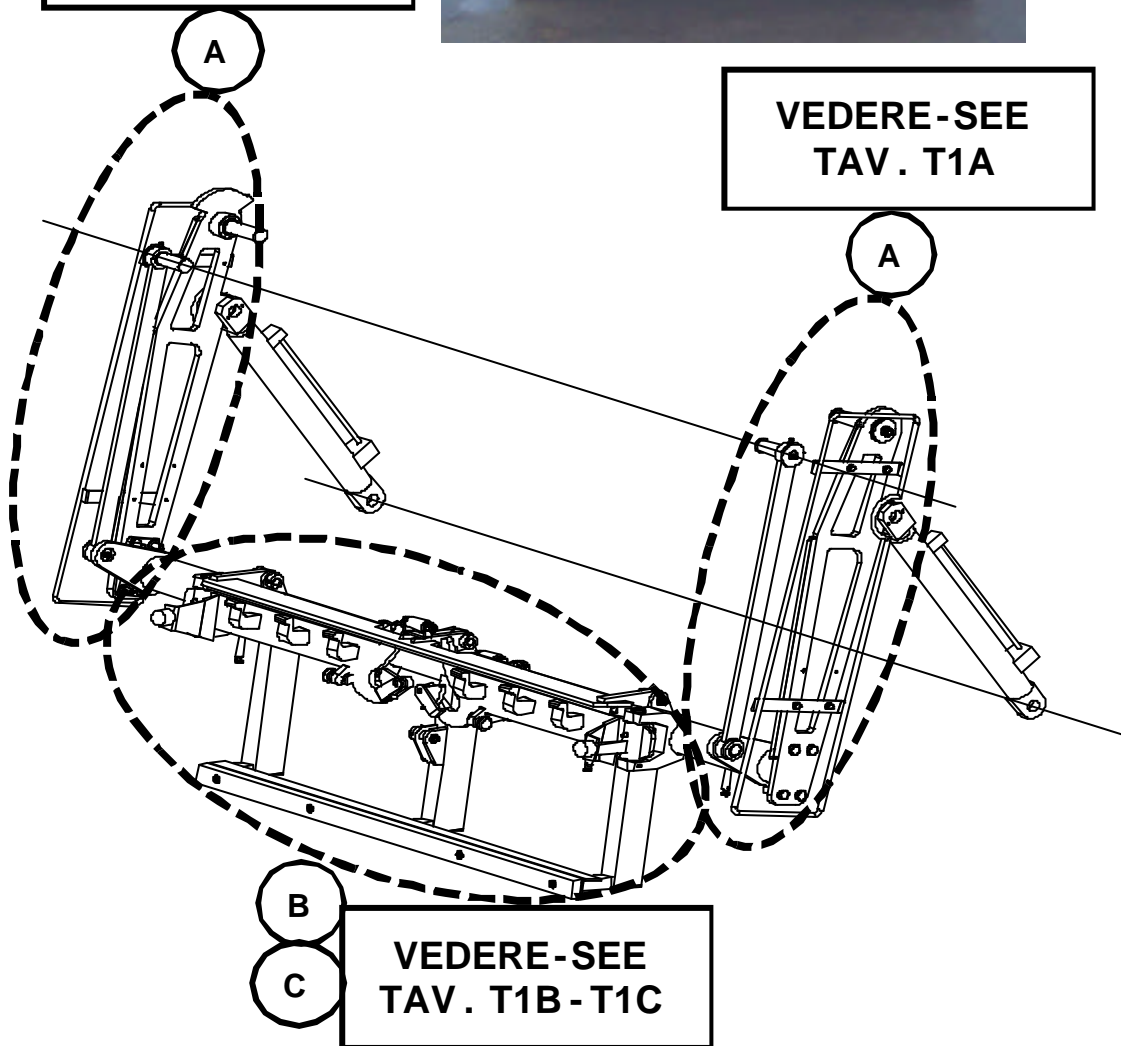

**VEDERE-SEE**  
**TAV. T1A**



**VEDERE-SEE**  
**TAV. T1A**

**B**  
**C**  
**VEDERE-SEE**  
**TAV. T1B-T1C**

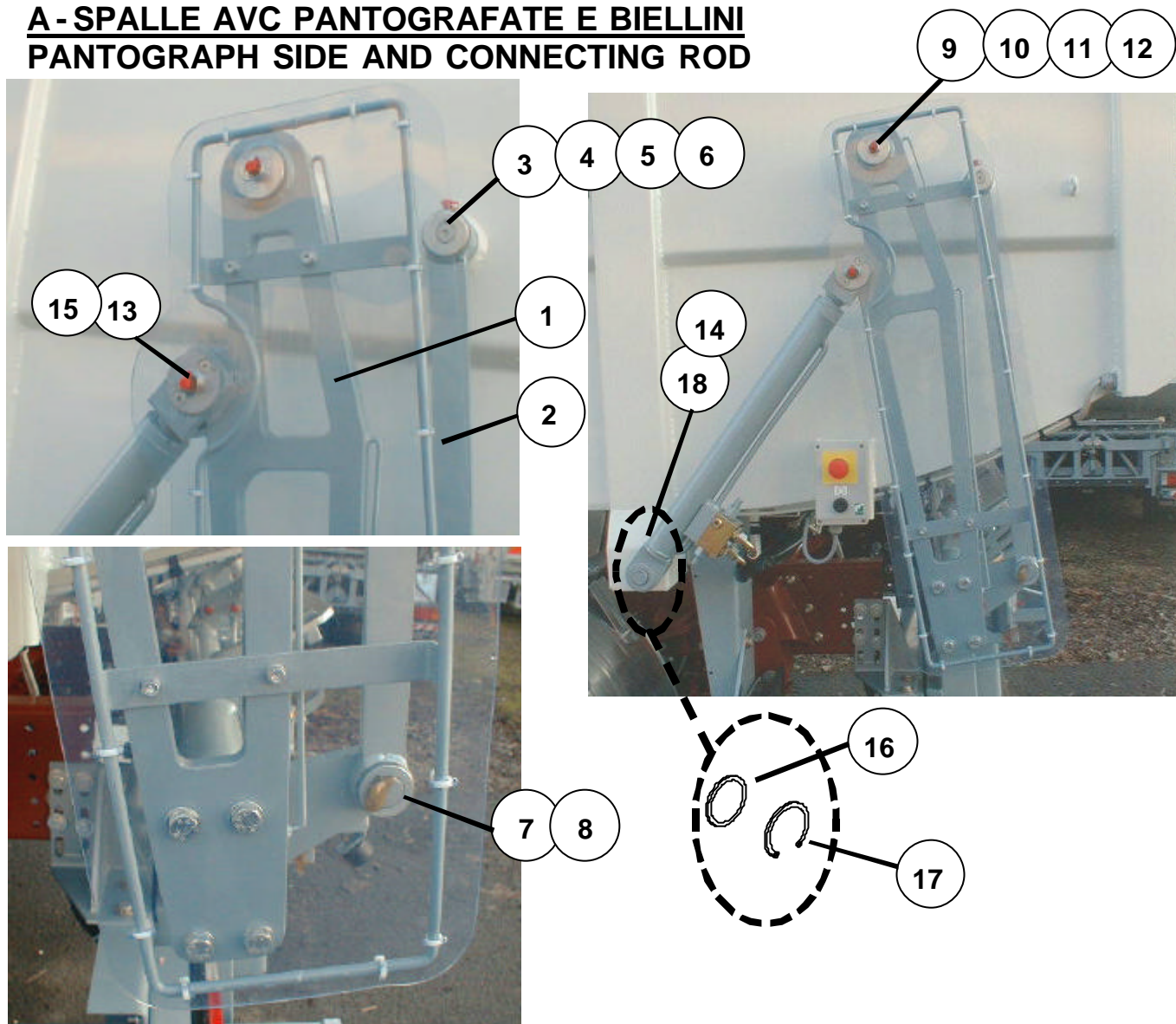
## A - SPALLE AVC PANTOGRAFATE E BIELLINI PANTOGRAPH SIDE AND CONNECTING ROD



| TAV | POS | CODICE      | DESCRIZIONE     | DESCRIPTION             | Q.TY | NOTE                     |
|-----|-----|-------------|-----------------|-------------------------|------|--------------------------|
| T1A | 1   | 03220003144 | SPALLA DESTRA   | RIGHT SIDE - PANTOGRAPH | 1    |                          |
| T1A | 1   | 03220003143 | SPALLA SINISTRA | LEFT SIDE - PANTOGRAPH  | 1    |                          |
| T1A | 2   | 03220003145 | BIELLINO        | CONNECTING ROD          | 2    |                          |
| T1A | 3   | 03220003305 | PERNO SALDATO   | PIN WELDED              | 2    | CON RONDELLA-WITH WASHER |
| T1A | 4   | 08170001289 | BOCCOLA         | BUSH                    | 4    |                          |
| T1A | 5   | 08060001287 | RONDELLA        | WASHER                  | 2    |                          |
| T1A | 6   | 08240001006 | INGRASSATORE    | GREASE NIPPLE           | 2    |                          |
| T1A | 7   | 08060001008 | ANELLO          | DONUT                   | 2    |                          |
| T1A | 8   | 08170001274 | BOCCOLA         | BUSH                    | 2    |                          |
| T1A | 9   | 03220003302 | PERNO SALDATO   | PIN WELDED              | 2    | CON RONDELLA-WITH WASHER |
| T1A | 10  | 08170001287 | BOCCOLA         | BUSH                    | 2+2  |                          |
| T1A | 11  | 03220003303 | RONDELLA        | WASHER                  | 2    |                          |
| T1A | 12  | 08020001955 | VITE            | SCREW                   | 2    |                          |
| T1A | 13  | 08010001357 | PERNO           | PIN                     | 2    |                          |
| T1A | 14  | 08170001288 | SNODO SFERICO   | SPHERIC SNODE           | 2    |                          |
| T1A | 15  | 08240001006 | INGRASSATORE    | GREASE NIPPLE           | 2    |                          |
| T1A | 16  | 08060001208 | RONDELLA        | WASHER                  | 2    | PER FISSAGGIO CILINDRO   |
| T1A | 17  | 08070001031 | ANELLO SEEGER   | DONUT-SEEGER            | 2    | FOR FIXING CYLINDER      |
| T1A | 18  | 03220003564 | PERNO SALDATO   | PIN WELDED              | 2    |                          |



**B - PETTINE PER VOLTACONTENITORI Lt 1100 DIN**  
**MOVING FRAME ( COMB )FOR BIN LIFT Lt 1100 DIN**

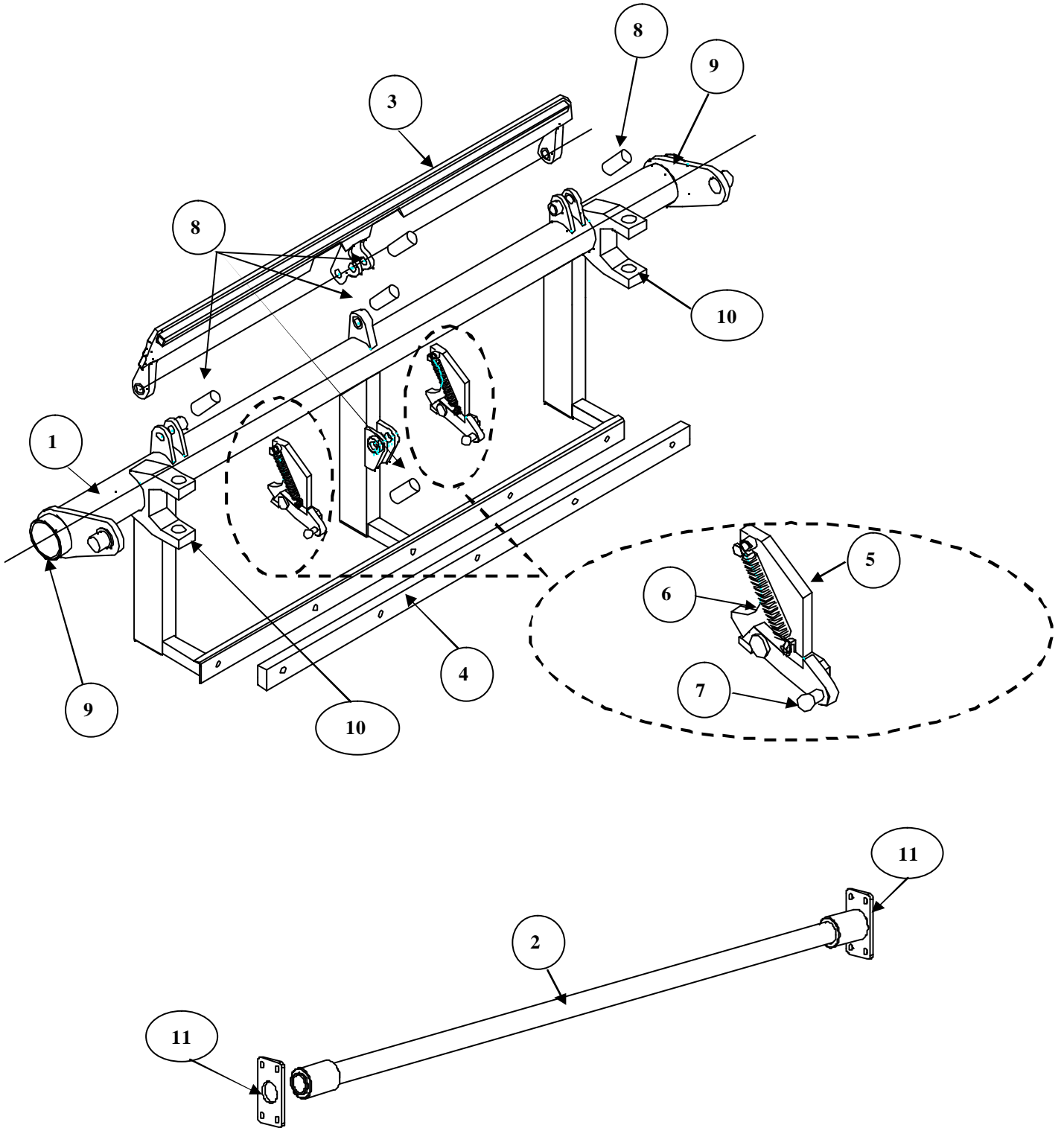

**B - PETTINE PER VOLTACONTENITORI Lt 1100 DIN**  
**MOVING FRAME ( COMB ) FOR BIN LIFT Lt 1100 DIN**

| TAV | POS | CODICE      | DESCRIZIONE          | DESCRIPTION              | Q.TY | NOTE             |
|-----|-----|-------------|----------------------|--------------------------|------|------------------|
| T1B | 1   | 03220003087 | BARRA ESTERNA        | EST. - BAR               | 1    |                  |
| T1B | 2   | 03220005173 | BARRA INTERNA        | INT. - BAR               | 1    | COMPLETA-COMLETE |
| T1B | 3   | 03220005148 | RISCONTRO<br>PETTINE | SUPPORT-<br>MOVING-FRAME | 1    |                  |
| T1B | 4   | 03220003088 | RISCONTRO NYLON      | SUPPORT-NYLON            | 1    |                  |
| T1B | 5   | 03220003132 | CHIAVISTELLO         | DOOR LATCH               | 1    | DESTRO-RIGHT     |
|     |     | 03220003133 | BRACCI COMPLETO      | COMPLETE                 | 1    | SINISTRO-LEFT    |
| T1B | 6   | 08300001029 | MOLLA                | SPRING                   | 2    |                  |
| T1B | 7   | 08290001052 | POMELLO A SFERA      | KNOB-SPHERE              | 2    |                  |
| T1B | 8   | 03220003130 | PERNO                | PIN                      | 5    |                  |
| T1B | 9   | 08170001276 | BOCCOLA              | BUSH                     | 2    |                  |
| T1B | 10  | 03220003202 | MAGNONE BRACCI       | SUPPORT ARMS             | 2    |                  |
| T1B | 11  | 03220003387 | FLANGIA-BARRONE      | FLANGE                   | 2    |                  |

**NOTA PER POSIZIONE 2**  
**NOTE FOR POSITION 2**

LA BARRA INTERNA (2) COMPLETA VERRA' FORNITA CON UNA  
 FLANGIA (11) NON SALDATA SU UN LATO

THE INTERNAL BAR (2) COMPLETE WILL BE' FURNISHED WITH  
 ONE FLANGE (11) NOT WELDED

**PAGINA**  
**SHEET**

**2/2**

TAV.T1B

FARID Industrie S.p.A

## C - BRACCI E PETTINE PER VOLTACONTENITORI Lt 1100 DIN

### ARM AND MOVING FRAME FOR BIN LIFT Lt. 1100 DIN

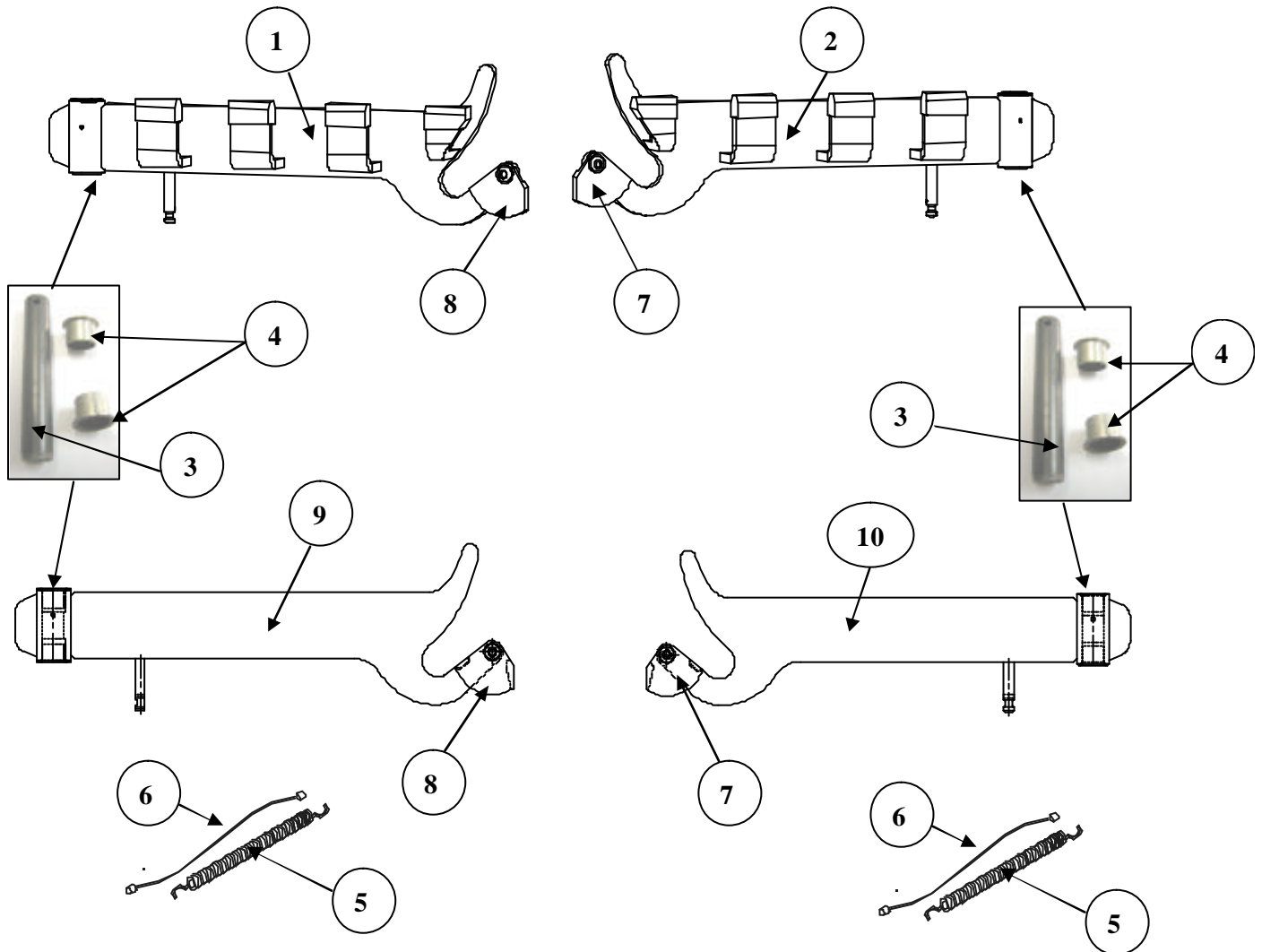

| TAV | POS | CODICE / CODE              | DESCRIZIONE         | DESCRIPTION           | Q.TY   | NOTE            |
|-----|-----|----------------------------|---------------------|-----------------------|--------|-----------------|
| T1C | 1   | 03220004157                | BRACCIO SINISTRO    | ARM - LEFT            | 1      |                 |
| T1C | 2   | 03220004158                | BRACCIO DESTRO      | ARM - RIGHT           | 1      |                 |
| T1C | 3   | 08010001281                | PERNO               | PIN                   | 2      |                 |
| T1C | 4   | 08170001118                | BOCCOLA             | BUSH                  | 4      |                 |
| T1C | 5   | 08300001064                | MOLLA               | SPRING                | 2      |                 |
| T1C | 6   | 08200001057<br>08200001081 | CAVETTO<br>MORSETTO | LITTLE CABLE<br>CLAMP | 2<br>4 |                 |
| T1C | 7   | 03220003361                | PENDOLO SICUREZZA   | SAFETY PENDULUM       | 1      | DESTRO-RIGHT    |
| T1C | 8   | 03220003362                | PENDOLO SICUREZZA   | SAFETY PENDULUM       | 1      | SINISTRO - LEFT |
| T1C | 9   | 03220003525                | BRACCIO SINISTRO    | ARM - LEFT            | 1      |                 |
| T1C | 10  | 03220003524                | BRACCIO DESTRO      | ARM - RIGHT           | 1      |                 |

## PROTEZIONE LATERALE IN PVC LATERAL PROTECTION IN PVC

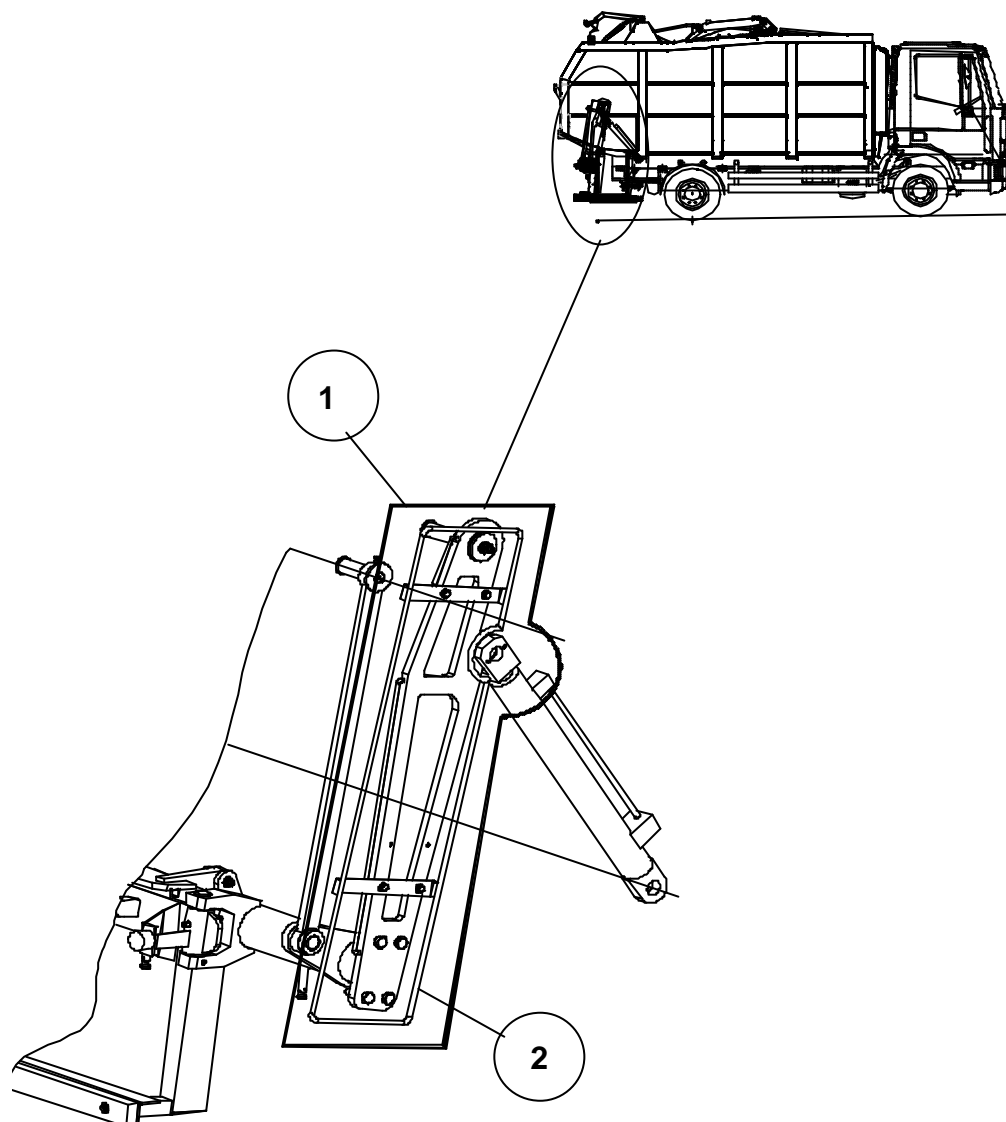

| TAV | POS | CODICE      | DESCRIZIONE                    | DESCRIPTION            | Q.TY | NOTE            |
|-----|-----|-------------|--------------------------------|------------------------|------|-----------------|
| T1D | 1   | 08330001053 | PROTEZIONE IN PVC              | PVC PROTECTION         | 2    |                 |
| T1D | 2   | 03130001128 | SUPPORTO PER PROTEZIONE<br>PVC | SUPPORT PVC PROTECTION | 2    | DESTRO - RIGHT  |
| T1D | 2   | 03130001129 | SUPPORTO PER PROTEZIONE<br>PVC | SUPPORT PVC PROTECTION | 2    | SINISTRO - LEFT |

## PALA COMPATTAZIONE PACKER PLATE

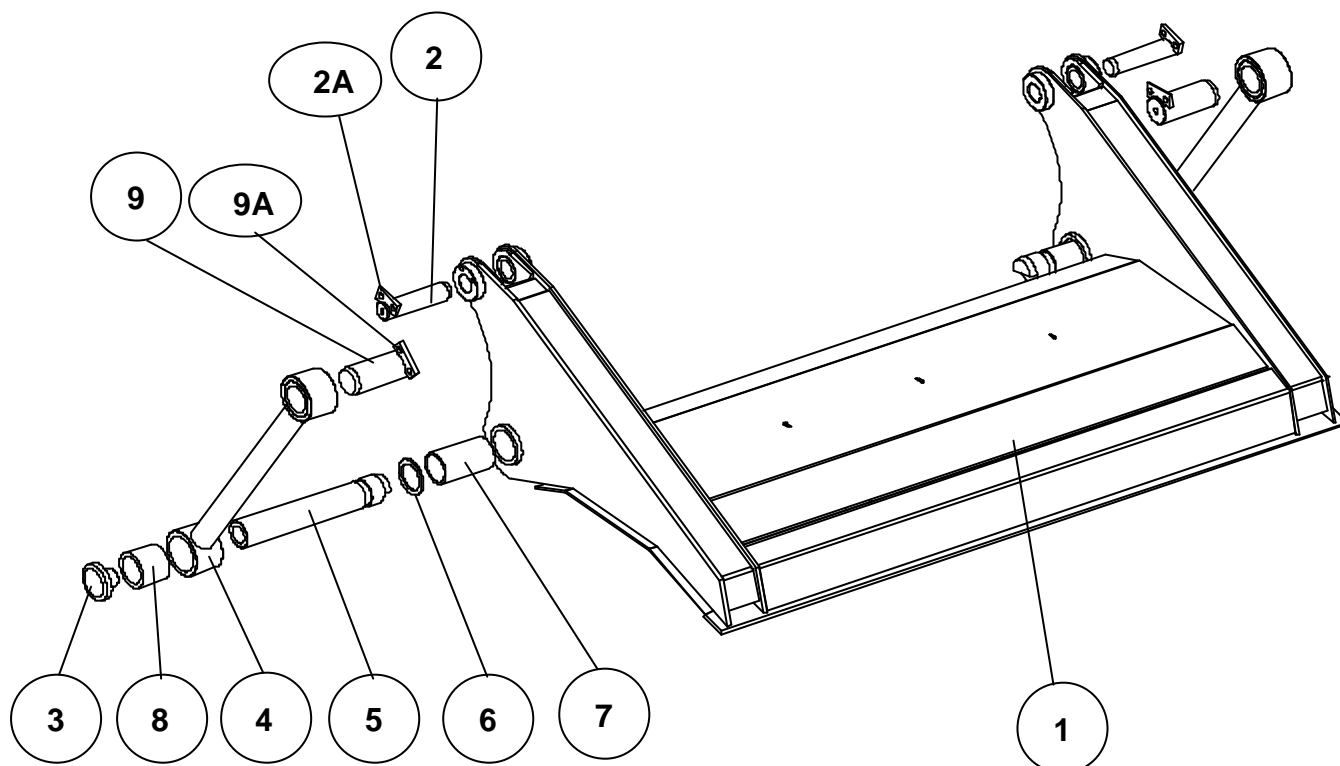

| TAV | POS | CODICE      | DESCRIZIONE              | DESCRIPTION   | Q.TY | NOTE |
|-----|-----|-------------|--------------------------|---------------|------|------|
| T2  | 1   | 03100001359 | PALA                     | PACKER PLATE  | 1    |      |
| T2  | 2   | 03100001373 | PERNO                    | PIN           | 2    |      |
| T2  | 2A  | 03090001351 | PIASTRINA                | PLATE         | 2    |      |
| T2  | 3   | 08160001484 | FONDELLO                 | PLUG          | 2    |      |
| T2  | 4   | 03170001514 | BIELLA                   | CONNECTIN ROD | 2    |      |
| T2  | 5   | 08010001346 | PERNO ARTICOLAZIONE PALA | PIN           | 2    |      |
| T2  | 6   | 08160001458 | RONDELLA                 | WASHER        | 2    |      |
| T2  | 7   | 08160001455 | BOCCOLA                  | BUSH          | 2    |      |
| T2  | 8   | 08160001456 | BOCCOLA                  | BUSH          | 2    |      |
| T2  | 9   | 03100001372 | PERNO                    | PIN           | 2    |      |
| T2  | 9A  | 03090001350 | PIASTRINA                | PLATE         | 2    |      |

SL  
SL

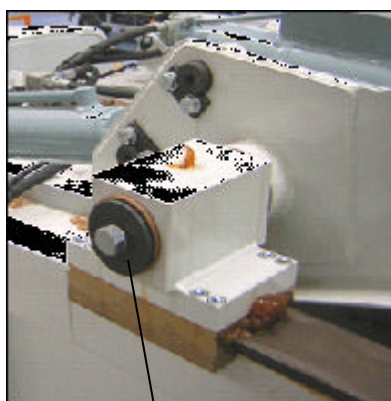
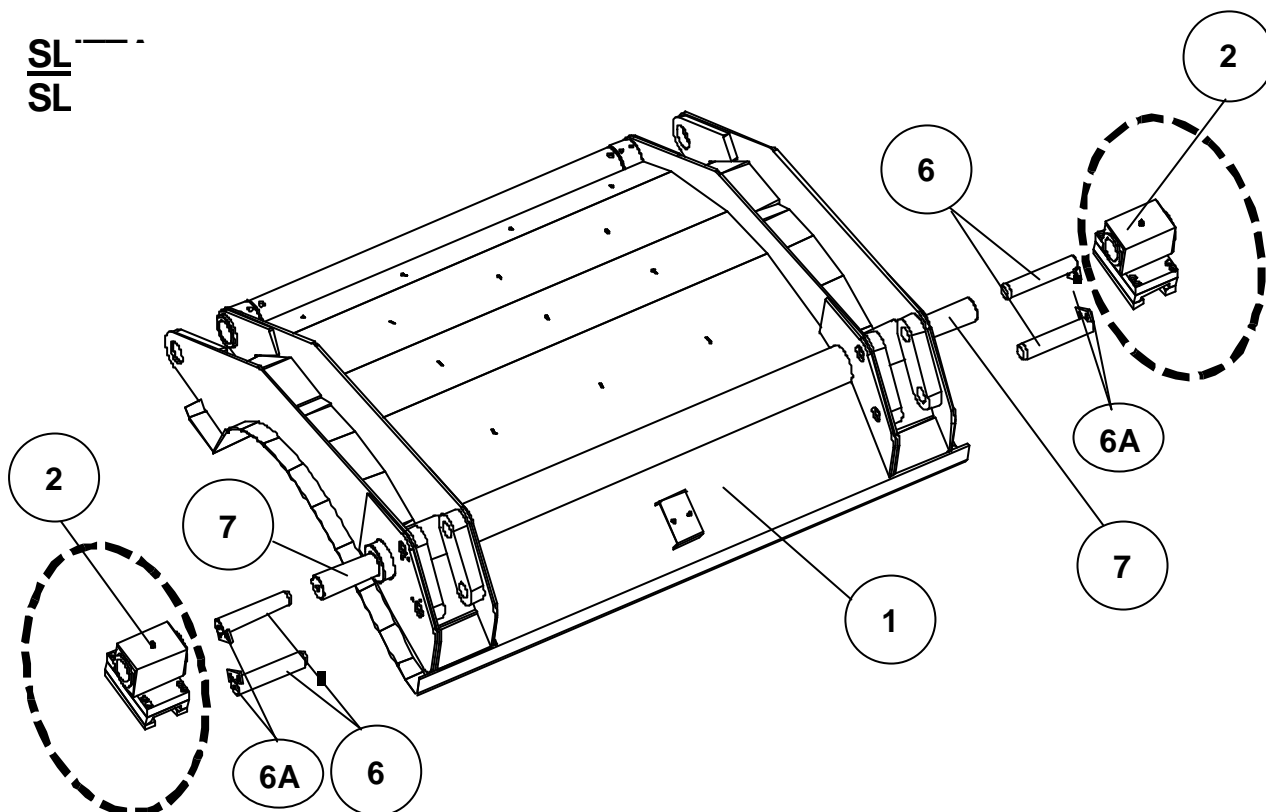

10

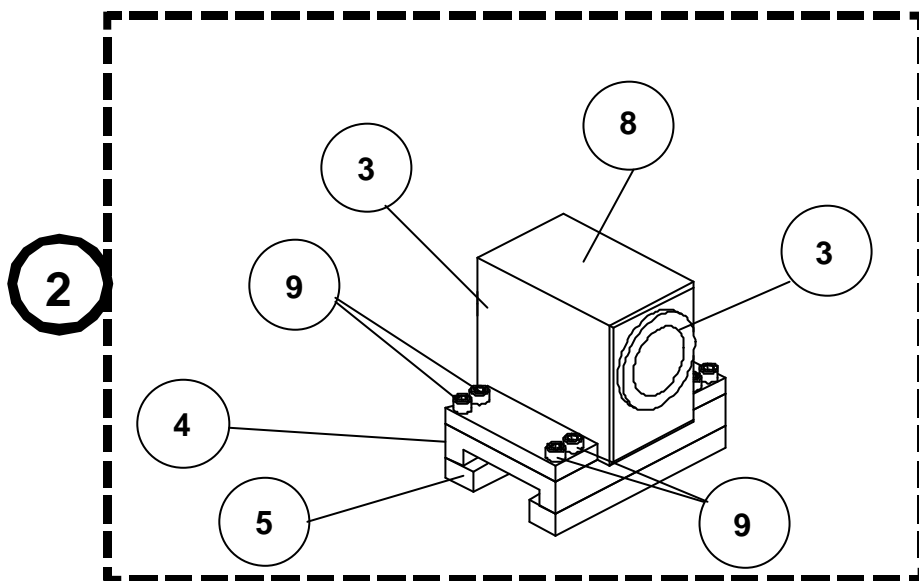

| TAV | POS | CODICE      | DESCRIZIONE                  | DESCRIPTION                 | Q.TY  | NOTE |
|-----|-----|-------------|------------------------------|-----------------------------|-------|------|
| T3  | 1   | 03170001512 | SLITTA - COMPLETA            | SLIDE - COMPLETE            | 1     |      |
| T3  | 2   | 03170001513 | SCATOLA GUIDA - COMPLETA     | SLIDE BOX - COMPLETE        | 2     |      |
| T3  | 3   | 08160001469 | BOCCOLA                      | BUSH                        | 4     |      |
| T3  | 4   | 08250001151 | PATTINO PER SCATOLA GUIDA    | PAD FOR SLIDE BOX           | 2     |      |
| T3  | 5   | 08250001152 | CONTROPATTINO PER SCATOLA G. | SUPPORT - PAD FOR SLIDE BOX | 2 + 2 |      |
| T3  | 6   | 03100001374 | PERNO                        | PIN                         | 4     |      |
| T3  | 6A  | 03090001351 | PIASTRINA                    | PLATE                       | 4     |      |
| T3  | 7   | 03170001556 | PERNO SALDATO                | PIN WELDED                  | 2     |      |
| T3  | 8   | 03170001534 | BLOCCHETTO X SCATOLA GUIDA   | BLOCK FOR SLIDE BOX         | 2     |      |
| T3  | 9   | 08020001572 | VITE T.C.E.I. 10x1,5 x 80    | SCREW T.C.E.I. 10x1,5 x 80  | 8 + 8 |      |
| T3  | 10  | 03170001552 | RONDELLA                     | WASHER                      | 2     |      |

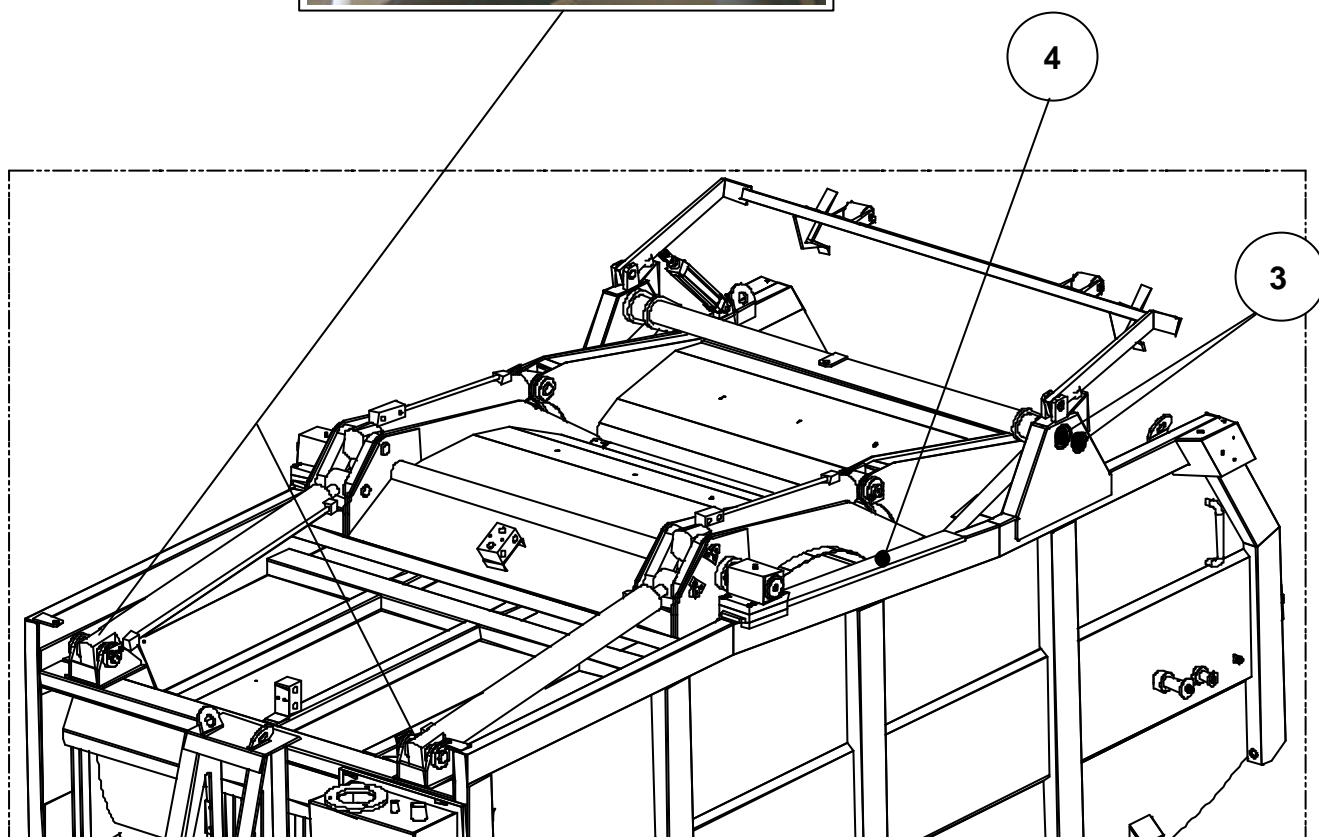
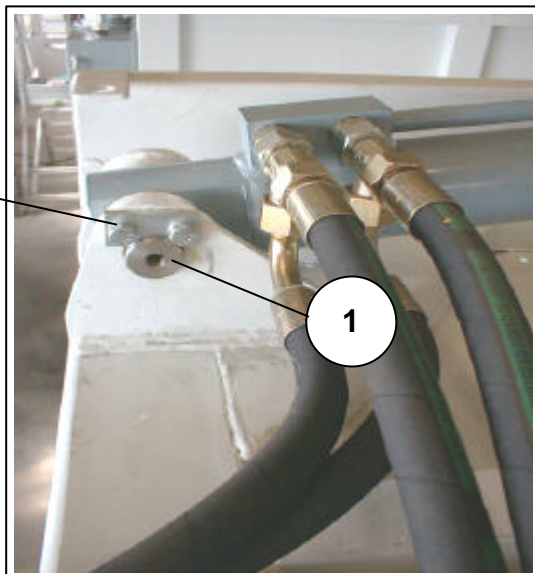
**TETTO FISSO**  
**FIXED ROOF**

| TAV | POS | CODICE      | DESCRIZIONE                | DESCRIPTION       | Q.TY | NOTE |
|-----|-----|-------------|----------------------------|-------------------|------|------|
| T4  | 1   | 03100001373 | PERNO                      | PIN               | 2    |      |
| T4  | 2   | 03090001351 | PIASTRINA                  | PLATE             | 2    |      |
| T4  | 3   | 09030001242 | TAPPO CHIUSURA IN PLASTICA | PLASTIC PLUG      | 2+2  |      |
| T4  | 4   | 03010004814 | PIASTRA GUIDA SLITTA       | PLATE SLAID SLIDE | 2    |      |

## PARATIA ESPULSIONE EJECTION PLATE

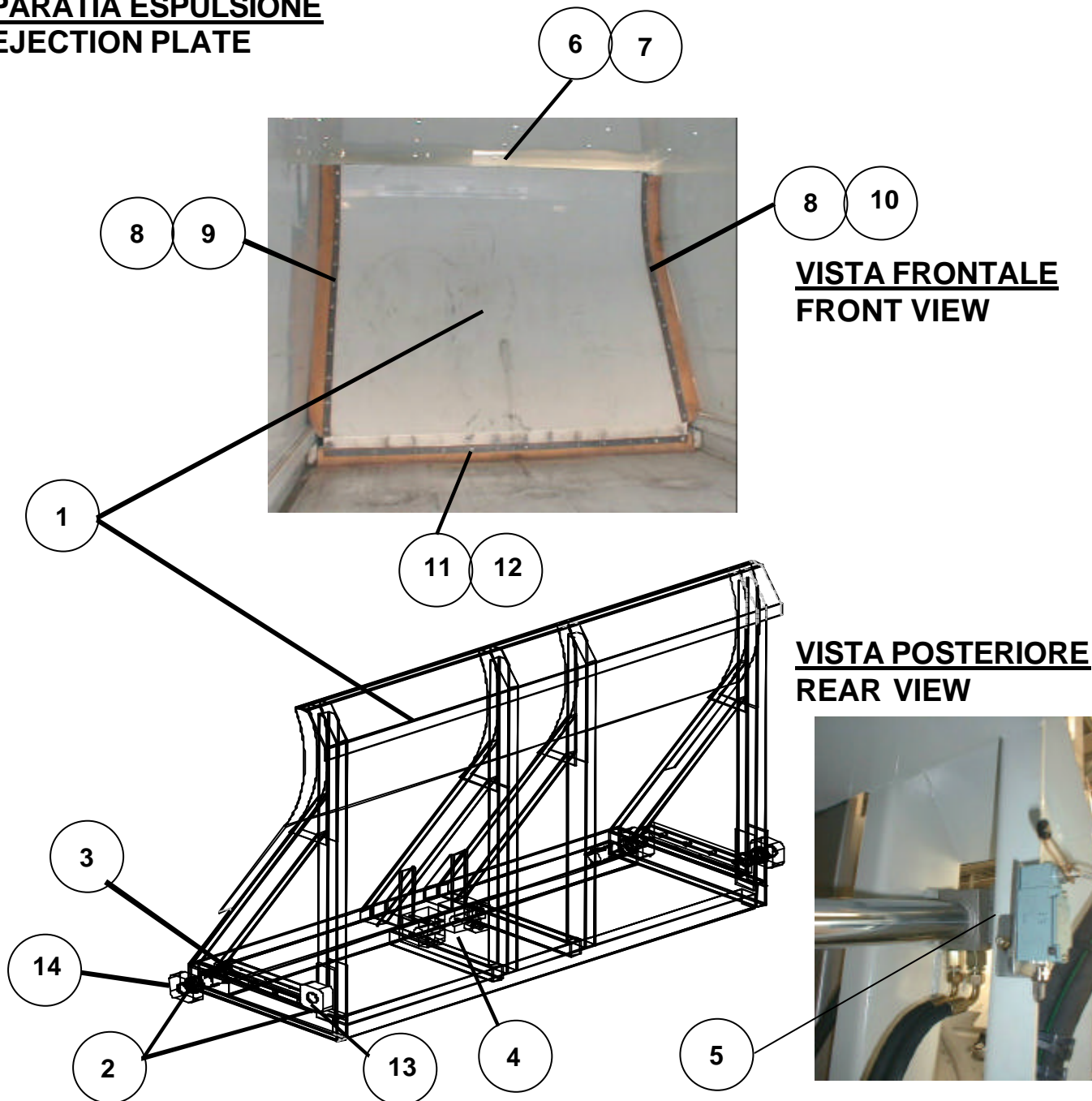

| TAV | POS | CODICE      | DESCRIZIONE                    | DESCRIPTION            | Q.TY | NOTE           |
|-----|-----|-------------|--------------------------------|------------------------|------|----------------|
| T5  | 1   | 03110001553 | PARATIA ESPULSIONE             | EJECTION PLATE         | 1    |                |
| T5  | 2   | 08250001139 | PATTINO SCORRIMENTO            | PAD                    | 4    |                |
| T5  | 3   | 08250001153 | PATTINO LATERALE               | LATERAL PAD            | 2    |                |
| T5  | 4   | 08010001289 | PERNO INFERIORE ATTACCO CIL.   | INFERIOR PIN           | 1    |                |
| T5  | 5   | 08010001288 | PERNO SUPERIORE ATTACCO CIL.   | SUPERIOR PIN           | 1    |                |
| T5  | 6   | 08120001068 | BADERNA SUPERIORE              | TOP RUBBER             | 1    |                |
| T5  | 7   | 03110001591 | PIATTO FIX.BADERNA SUPERIORE   | FIXED PLATE TOP        | 1    |                |
| T5  | 8   | 08120001053 | BADERNA LATERALE               | SIDE RUBBER            | 2    |                |
| T5  | 9   | 03110001589 | PIATTO FIX.BADERNA LATERALE SX | FIXED PLATE SIDE LEFT  | 1    |                |
| T5  | 10  | 03110001588 | PIATTO FIX.BADERNA LATERALE DX | FIXED PLATE SIDE RIGHT | 1    |                |
| T5  | 11  | 08120001054 | BADERNA INFERIORE              | LOWER RUBBER           | 1    |                |
| T5  | 12  | 03110001590 | PIATTO FIX.BADERNA INFERIORE   | FIXED PLATE LOWER      | 1    |                |
| T5  | 13  | 08010001976 | PERNO ATTACCO PATTINO SUP.     | PIN FIXED PAD-SUPERIOR | 2    | SALDATO-WELDED |
| T5  | 14  | 08010001977 | PERNO ATTACCO PATTINO INF.     | PIN FIXED PAD-INFERIOR | 2    | SALDATO-WELDED |



**SPONDINA POSTERIORE A CHIUSURA ELASTICA**  
**REAR FLAP- ELASTIC CLOSING**

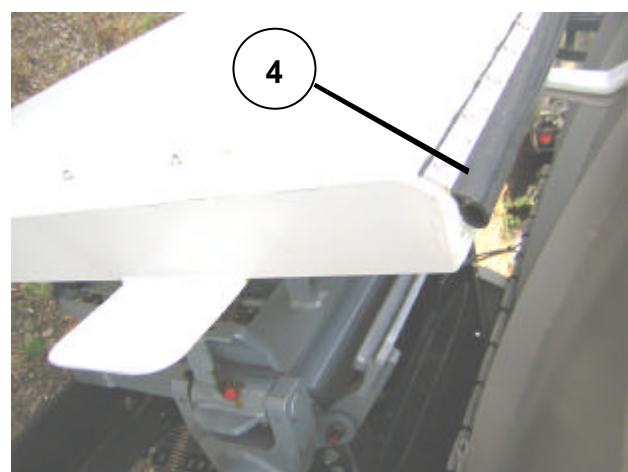
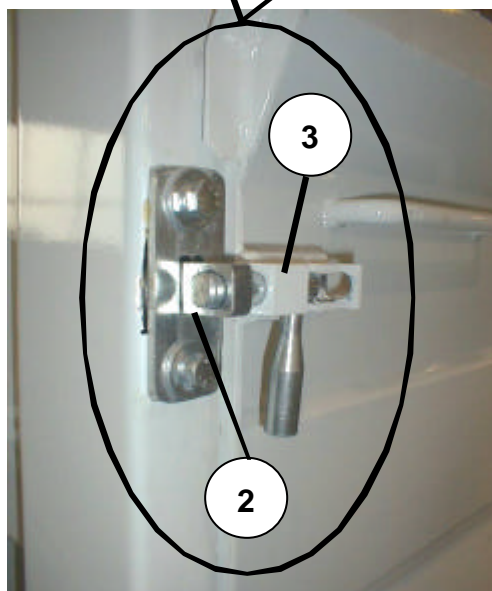
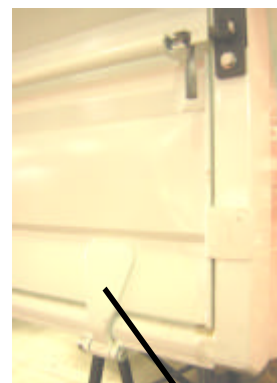
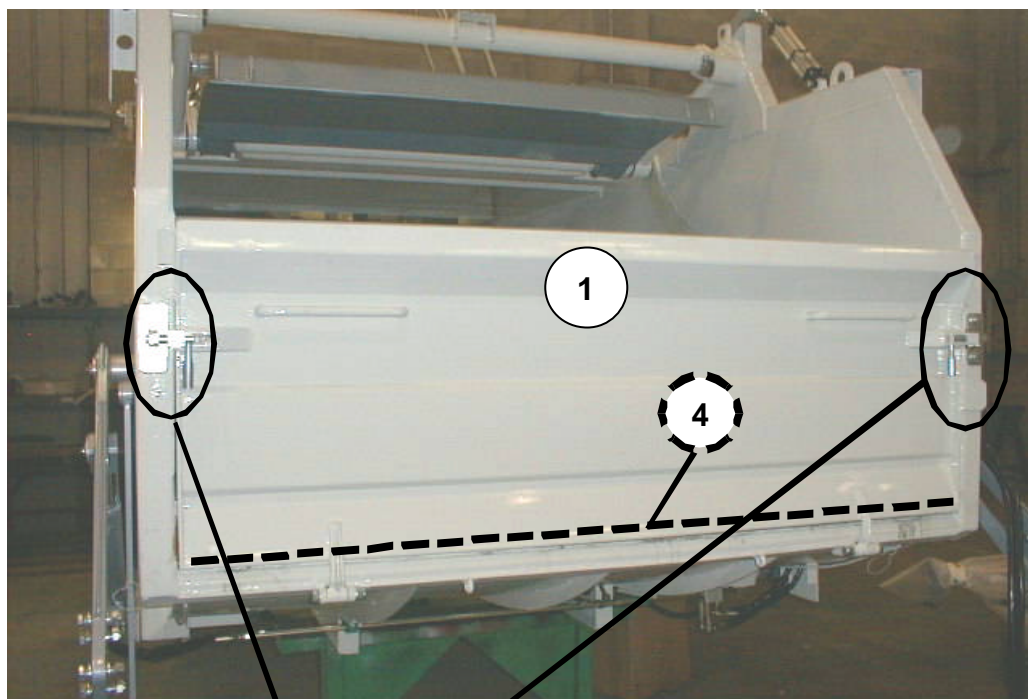

| TAV | POS | CODICE      | DESCRIZIONE                     | DESCRIPTION          | Q.TY | NOTE            |
|-----|-----|-------------|---------------------------------|----------------------|------|-----------------|
| T6  | 1   | 03190001260 | SPONDINA POSTERIORE<br>COMPLETA | REAR FLAP - COMPLETE | 1    |                 |
| T6  | 2   | 03190001274 | KIT DISPOSITIVO A MOLLA         | KIT DEVICE SPRING    | 2    |                 |
| T6  | 3   | 03190001045 | CHIAVISTELLO                    | LATCH                | 2    |                 |
| T6  | 4   | 03190001227 | GUARNIZIONE INTERNA             | INTERNAL SEAL        | 1    | L = 180 Cm      |
|     |     | 07040001185 | PIATTO FERMO GUARNIZIONE        | BAR FOR STOP SEAL    | 1    | <b>OPTIONAL</b> |
| T6  | 5   | 03190001402 | CERNIERA RINFORZATA             | HINGE                | 2    |                 |

## SERBATOIO OLIO E ACCESSORI OIL TANK AND ACCESSORIES



3



10

11

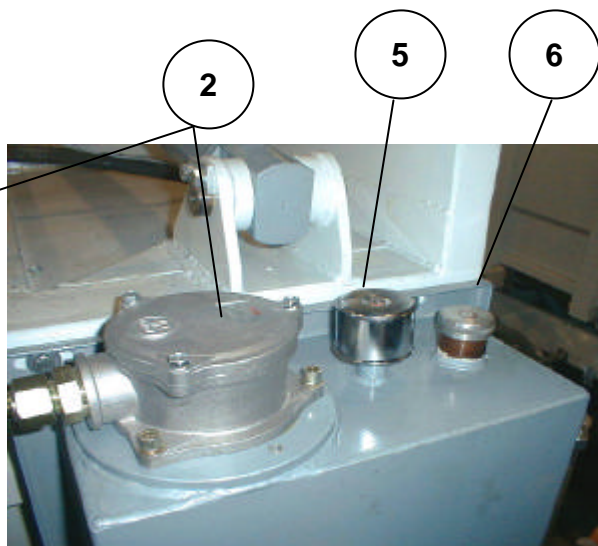

2

5

6



4

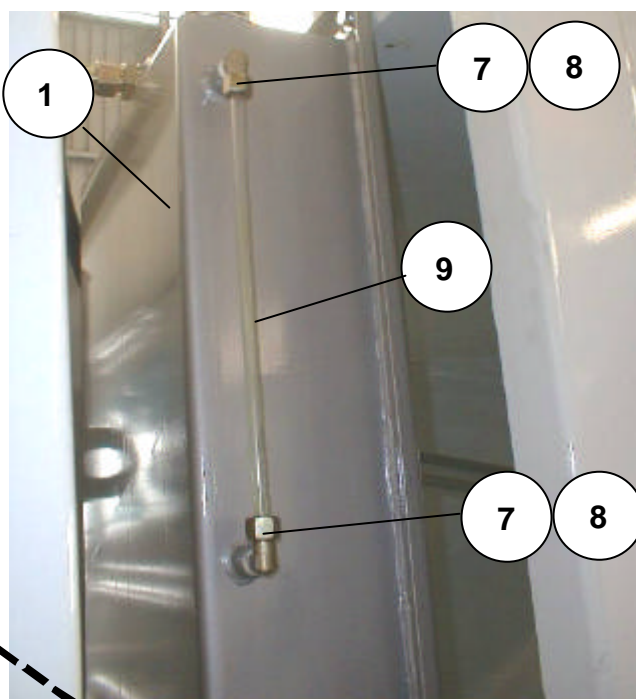

1

7

8

9

7

8

| TAV | POS | CODICE/CODE | DESCRIZIONE          | DESCRIPTION         | Q.TY | NOTE |
|-----|-----|-------------|----------------------|---------------------|------|------|
| T7  | 1   | 03160001292 | SERBATOIO OLIO       | OIL TANK            | 1    |      |
| T7  | 2   | 04140001204 | FILTRO OLIO COMPLETO | OIL FILTER COMPLETE | 1    |      |
| T7  | 3   | 04140001205 | CARTUCCIA FILTRO     | CARTRIDGE           | 1    |      |
| T7  | 4   | 04060001030 | SARAINESCA           | VALVE               | 1    |      |
| T7  | 5   | 04140001109 | FILTRO ARIA          | AIR FILTRE          | 1    |      |
| T7  | 6   | 04050002219 | TAPPO                | CAP                 | 1    |      |
| T7  | 7   | 04050001747 | RACCORDO 3/8"-12     | UNION 3/8" -12      | 2    |      |
| T7  | 8   | 04050001414 | OGIVA                |                     | 2    |      |
| T7  | 9   | 04100001163 | TUBO - 12            | TUBE- 12            | 1    |      |
| T7  | 10  | 04170001084 | FASCETTA             | CLAMP               | 1    |      |
| T7  | 11  | 04100001344 | TUBO SCARICO OLIO    | TUBE- DESCHARGE     | 1    |      |

## BARRA APRICOPERCHIO COVER BIN BAR

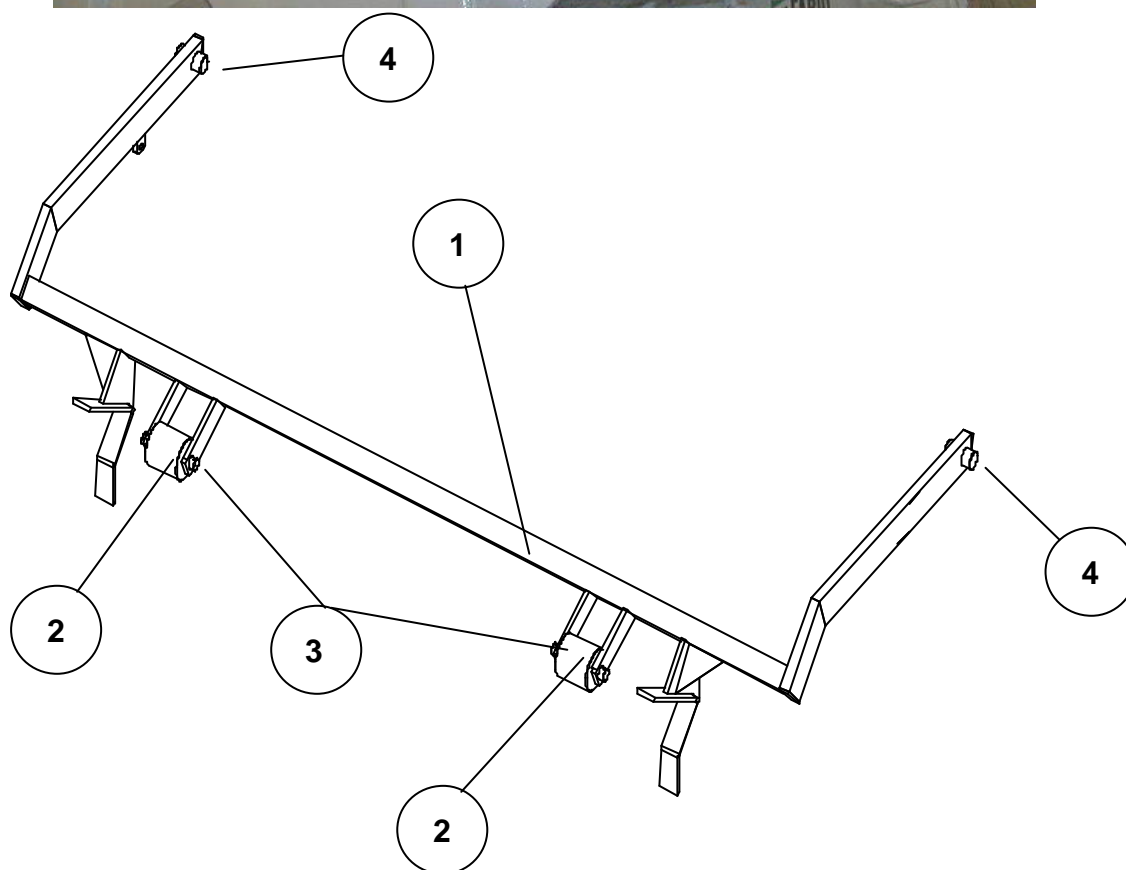

| TAV | POS | CODICE      | DESCRIZIONE    | DESCRIPTION    | Q.TY | NOTE |
|-----|-----|-------------|----------------|----------------|------|------|
| T8  | 1   | 03020001210 | BARRA COMPLETA | BAR - COMPLETE | 1    |      |
| T8  | 2   | 03020001209 | RULLO          | ROLLER         | 2    |      |
| T8  | 3   | 03020001241 | PERNO          | PIN            | 2    |      |
| T8  | 4   | 03020001240 | PERNO          | PIN            | 2    |      |
| T8  | 4   | 08160001527 | BOCCOLA        | BUSH           | 2    |      |



## ACCESSORI E TARGHETTE ADESIVE ACCESSORIES AND ADHESIVE LABELS



4



5



11

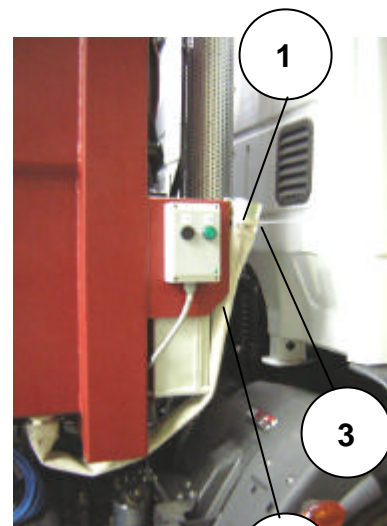

1

2

3

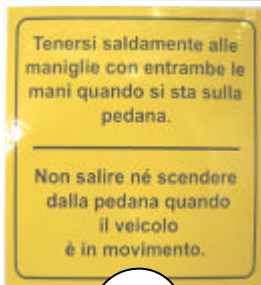

9



10



7

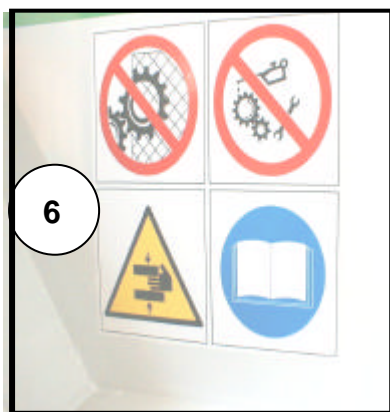

6

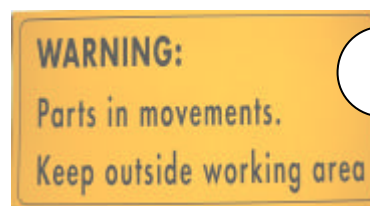

8

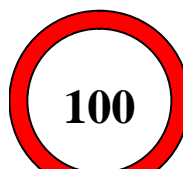

14

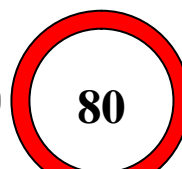

13

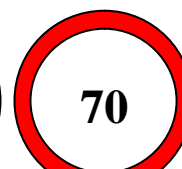

12

| TAV | POS | CODICE      | DESCRIZIONE                   | DESCRIPTION                  | Q.TY | NOTE             |
|-----|-----|-------------|-------------------------------|------------------------------|------|------------------|
| T9  | 1   | 03240001013 | BICCHIERE                     | END                          | 1    |                  |
| T9  | 2   | 04100001142 | TUBO TELATO                   | HOSE                         | 1    |                  |
| T9  | 3   | 04170001065 | FASCETTA                      | CLAMP                        | 2    |                  |
| T9  | 4   | 08280001346 | TARGA CE                      | PLATE CE                     | 1    |                  |
| T9  | 5   | 08280002650 | TARGA OLIO IDRAULICO          | PLATE HYDRAULIC OIL          | 1    |                  |
| T9  | 6   | 08280002582 | TARGA SICUREZZE               | PLATE SECURITY               | 2    |                  |
| T9  | 7   | 08280001332 | TARGA ATTENZIONE.....         | PLATE ATTENTION...           | 2    | ITALIANO-ITALIAN |
| T9  | 8   | 08280001336 | TARGA ATTENZIONE.....         | PLATE ATTENTION...           | 2    | INGLESE-ENGLISH  |
| T9  | 9   | 08280000014 | TARGA USO PEDANE              | PLATE PLATFORM USE           | 2    | ITALIANO-ITALIAN |
| T9  | 10  | 08280000015 | TARGA USO PEDANE              | PLATE PLATFORM USE           | 2    | INGLESE-ENGLISH  |
| T9  | 11  | 09020001226 | COPPIA PANNELLI RETRORIFLETT. | COUPLE PLATE BACK REFLECTING | 1    |                  |
| T9  | 12  | 08280001022 | TARGA VELOCITA' 70 Km         | PLATE - SPEED 70 Km          | 1    |                  |
| T9  | 13  | 08280001023 | TARGA VELOCITA' 80 Km         | PLATE - SPEED 80 Km          | 1    |                  |
| T9  | 14  | 09020001056 | TARGA VELOCITA' 100 Km        | PLATE - SPEED 100 Km         | 1    |                  |

## ACCESSORI ACCESSORIES

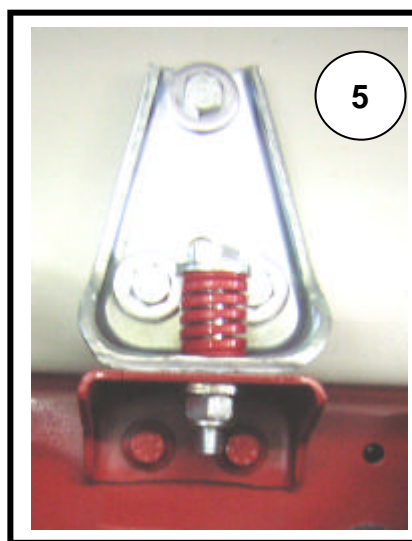
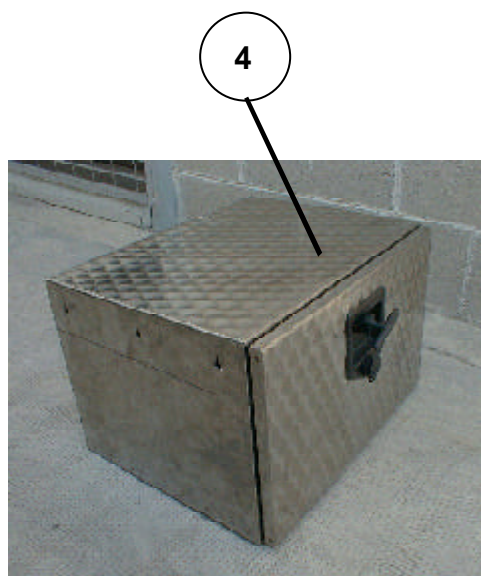
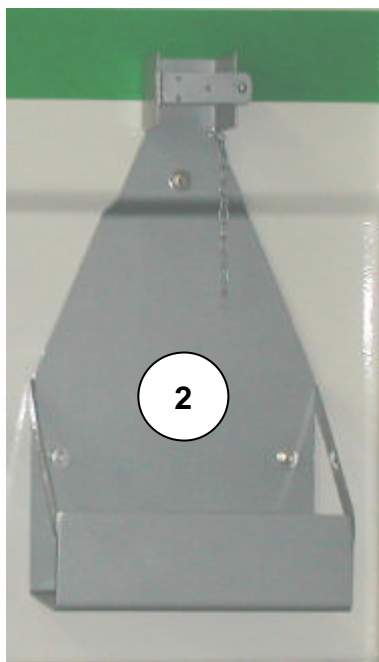
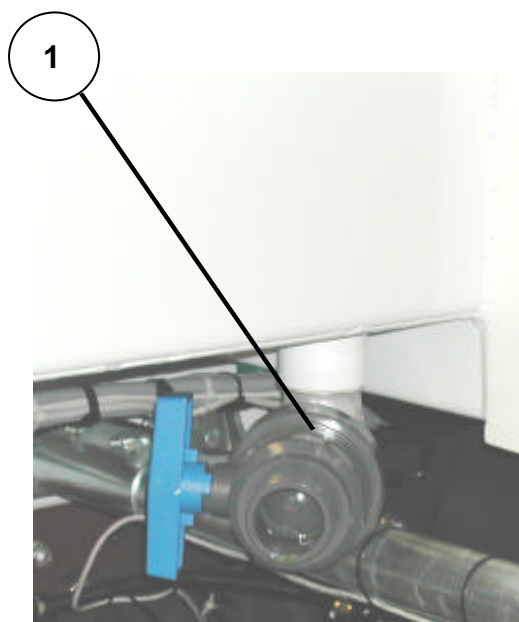

| TAV | POS | CODICE      | DESCRIZIONE                  | DESCRIPTION         | Q.TY | NOTE            |
|-----|-----|-------------|------------------------------|---------------------|------|-----------------|
| T9A | 1   | 04060001016 | VALVOLA LIQUAMI 2" PLASTICA  | VALVE 2"- PLASTIC   | 1    | OPTIONAL        |
| T9A | 2   | 09020001037 | PORTASCOPE                   | SUPPORT FOR BROOM   | 1    | OPTIONAL        |
| T9A | 3   | 04110001035 | TERMOMETRO SU SERBATOIO OLIO | TERMOMETER-OIL TANK | 1    | OPTIONAL        |
| T9A | 4   | 09020001043 | CASSETTA PORTATTREZZI        | TOOLS-BOX           | 1    | OPTIONAL        |
| T9A | 5   | 03080001124 | MENSOLA ANCORAGGIO           | BRACKET             |      | SP / THSS - 5mm |
|     |     | 08300001124 | MOLLA ROSSA                  | RED -SPRING         |      |                 |
|     |     | 08060001243 | RONDELLA PIANA 14x35         | WASHER - 14x35      |      |                 |
|     |     | 08020001988 | BULLONE- M14 x 2 10.9        | BOLT M14 x 2 10.9   |      |                 |
|     |     | 08030001111 | DADO M14                     | NUT M14             |      |                 |

# **IDRAULICA**

# **HYDRAULIC**

**CILINDRO PARATIA ESPULSIONE**  
**CYLINDER FOR EJECTION PLATE**

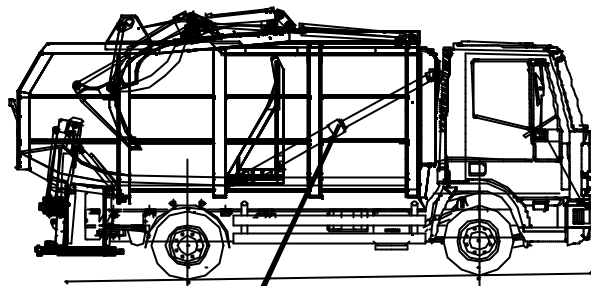

1

| TAV | POS | CODICE      | DESCRIZIONE         | DESCRIPTION                 | Q.TY | NOTE |
|-----|-----|-------------|---------------------|-----------------------------|------|------|
| T11 | 1   | 04070001887 | CILINDRO ESPULSIONE | CYLINDER FOR EJECTION PLATE | 1    |      |
| T11 | 1   | 04120002259 | KIT GUARNIZIONI     | SEAL                        | 1    |      |



## CILINDRI PALA CYLINDERS FOR PACKER PLATE PLATE

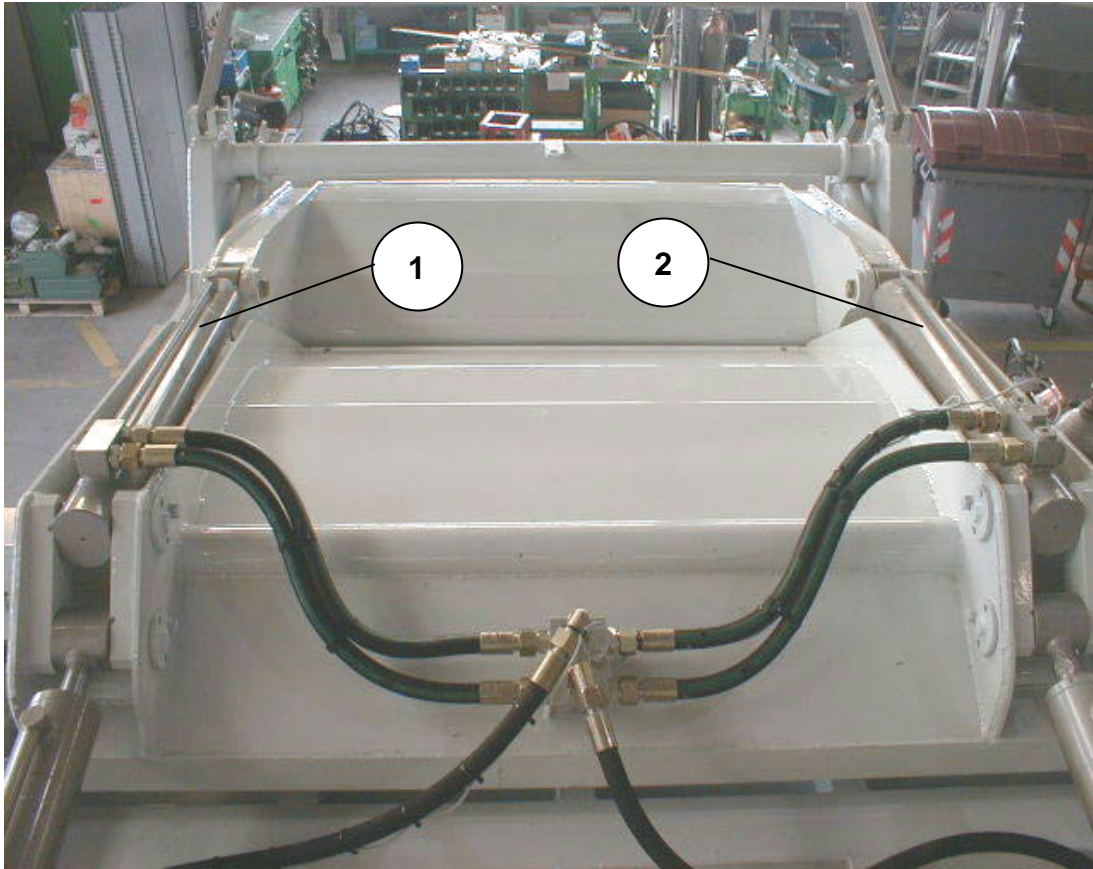

| TAV | POS | CODICE      | DESCRIZIONE               | DESCRIPTION          | Q.TY | NOTE |
|-----|-----|-------------|---------------------------|----------------------|------|------|
| T12 | 1   | 04070001845 | CILINDRO PALA             | CYLINDER             | 1    |      |
| T12 | 2   | 04070001846 | CILINDRO PALA CON SENSORE | CYLINDER WITH SENSOR | 1    |      |
| T12 | 1-2 | 04120002491 | KIT GUARNIZIONI           | SEAL                 | 2    |      |



## CILINDRI SLITTA CYLINDERS FOR SLIDE

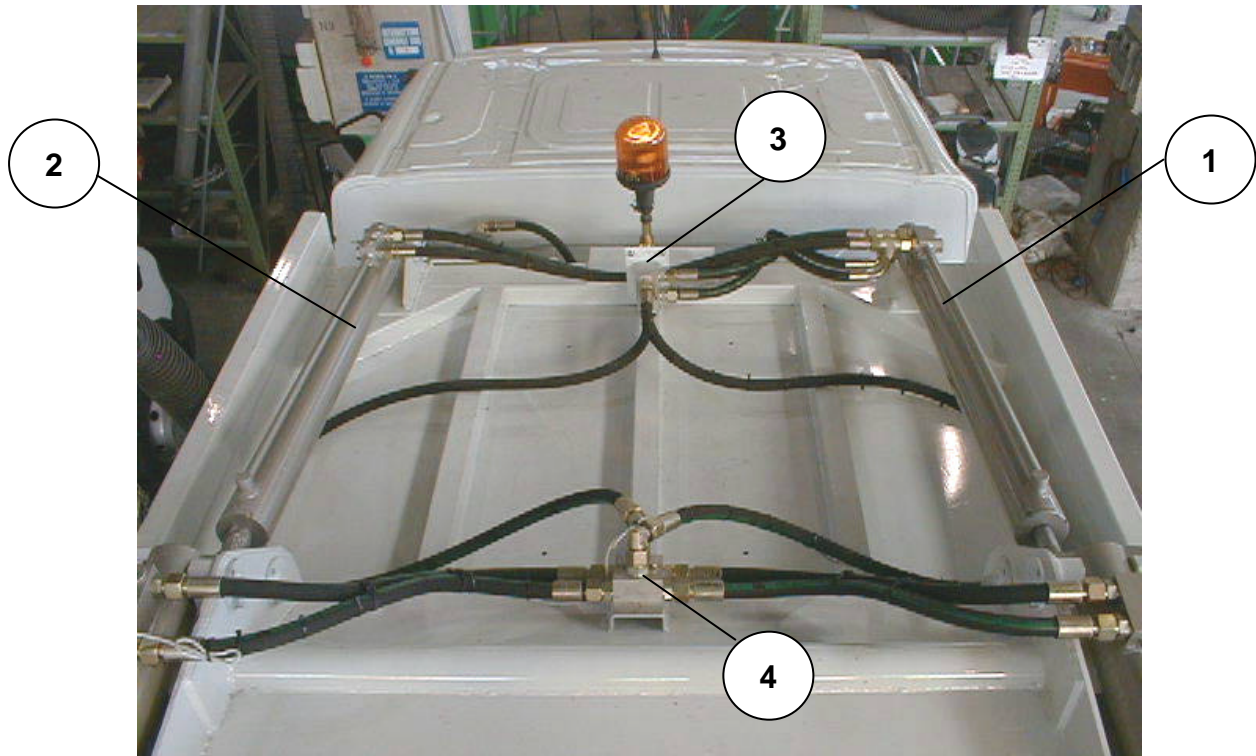

| TAV | POS | CODICE      | DESCRIZIONE            | DESCRIPTION          | Q.TY | NOTE |
|-----|-----|-------------|------------------------|----------------------|------|------|
| T13 | 1   | 04070001847 | CILINDRO               | CYLINDER             | 1    |      |
| T13 | 2   | 04070001848 | CILINDRO CON SENSORE   | CYLINDER WITH SENSOR | 1    |      |
| T13 | 1-2 | 04120002493 | KIT GUARNIZIONI        | SEAL                 | 2    |      |
| T13 | 3   | 04050002534 | BLOCCHETTO DERIVAZIONE | HYDRAULIC PARTICULAR | 1    |      |
| T13 | 4   | 04050002535 | BLOCCHETTO DERIVAZIONE | HYDRAULIC PARTICULAR | 1    |      |

## CILINDRI VOLTACONTENITORI CYLINDERS FOR BIN LIFT

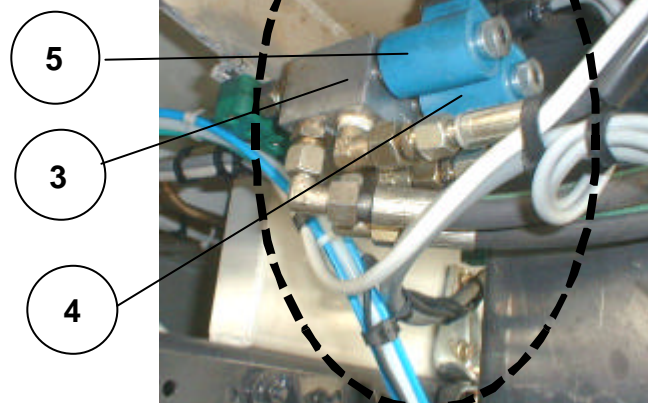
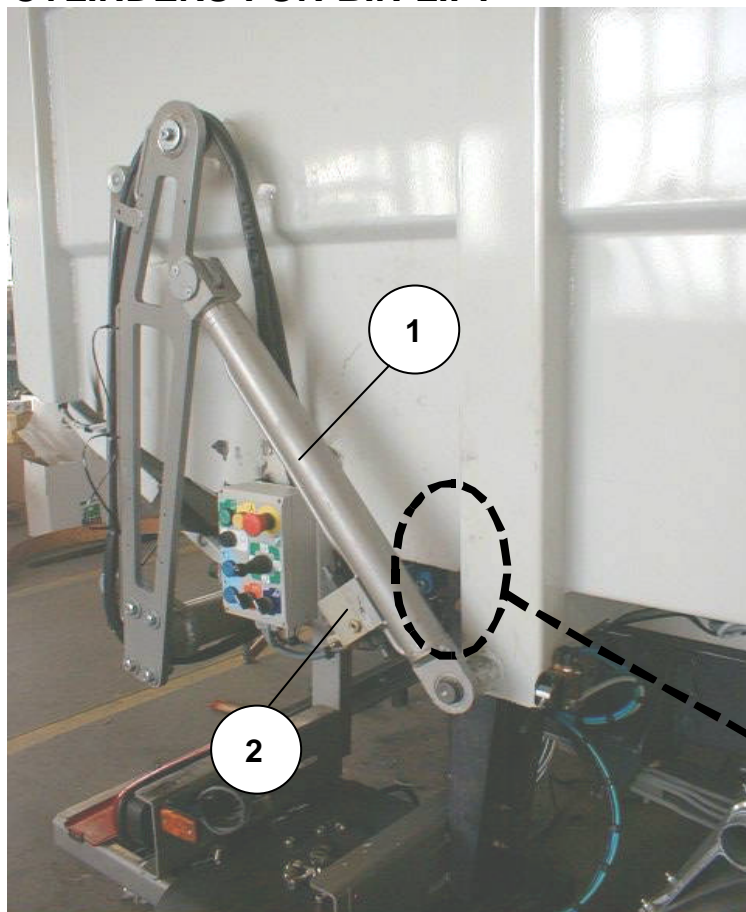

| TAV | POS | CODICE      | DESCRIZIONE               | DESCRIPTION           | Q.TY | NOTE   |
|-----|-----|-------------|---------------------------|-----------------------|------|--|
| T14 | 1   | 04070001840 | CILINDRO VOLTACONTENITORI | CYLINDER FOR BIN LIFT | 2    | COMPLETO-COMLETE                             |
| T14 | 1   | 04070001830 | CILINDRO VOLTACONTENITORI | CYLINDER FOR BIN LIFT | 2    | SENZA VALVOLA BLOCCO<br>WITHOUT SAFETY VALVE |
| T14 | 1   | 04120002473 | KIT GUARNIZIONI           | SEAL                  | 2    |  |
| T14 | 2   | 04040001639 | VALVOLA BLOCCO            | SAFETY VALVE          | 2    |  |
| T14 | 3   | 04040001411 | VALVOLA                   | VALVE                 | 1    |  |
| T14 | 4   | 05080001161 | SOLENOIDE - 12 V          | SOLENOID - 12 V       | 2    |  |
|     |     | 04040001217 | SOLENOIDE - 24 V          | SOLENOID - 24 V       | 2    |  |
|     |     | 05080001170 | CONNETTORE                | CONNECTOR             | 2    |  |
| T14 | 5   | 04040001640 | CURSORE                   | CURSOR                | 2    |  |

## CILINDRO PETTINE CYLINDER FOR MOVING FRAME

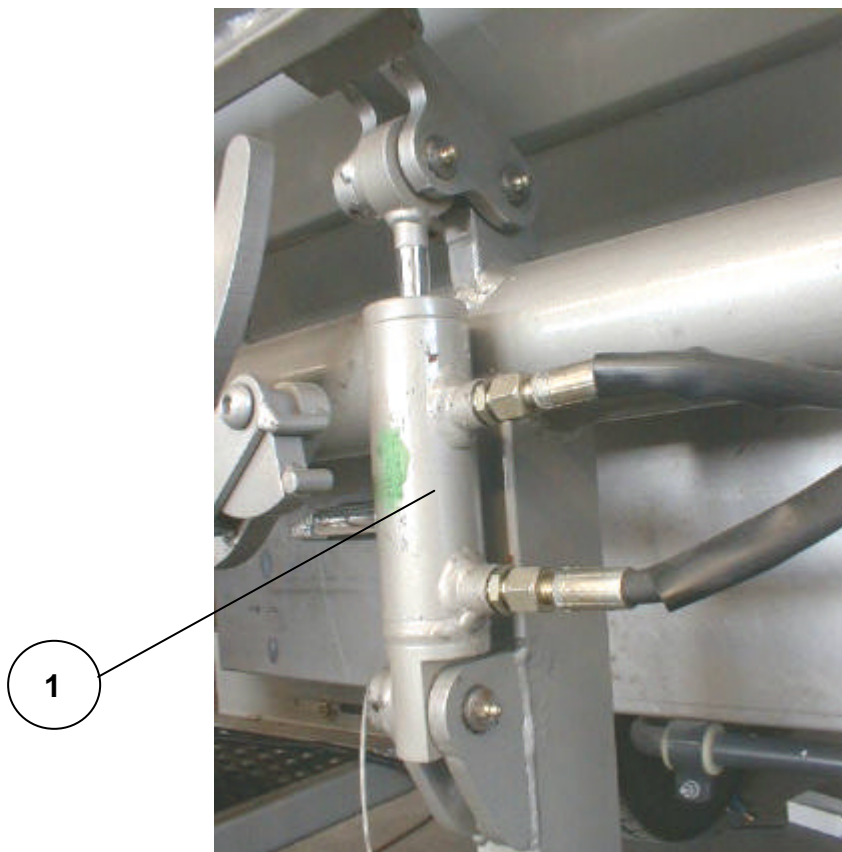
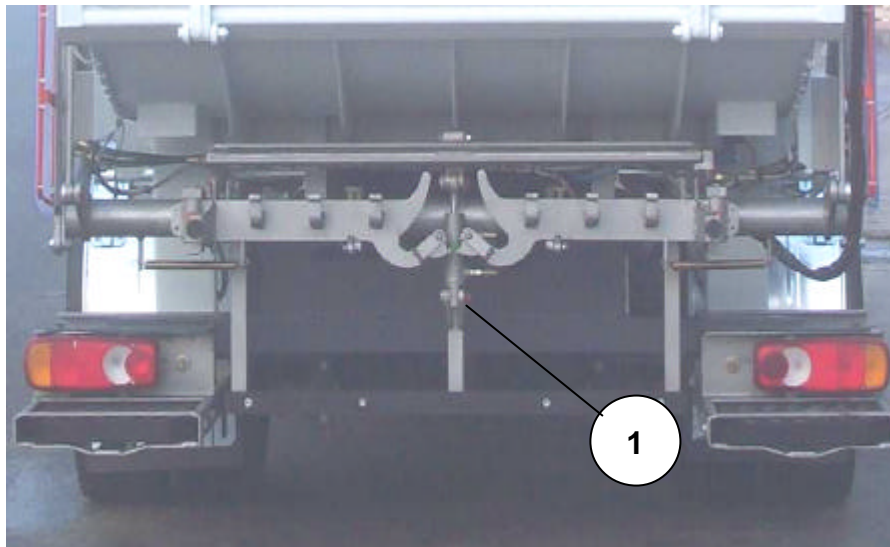

| TAV | POS | CODICE      | DESCRIZIONE      | DESCRIPTION               | Q.TY | NOTE |
|-----|-----|-------------|------------------|---------------------------|------|------|
| T15 | 1   | 04070001831 | CILINDRO PETTINE | CYLINDER FOR MOVING FRAME | 1    |      |
| T15 | 1   | 04120002029 | KIT GUARNIZIONI  | SEAL                      | 1    |      |



**DISTRIBUTORE COMPATTAZIONE**  
**OIL DISTRIBUTOR FOR COMPACTING**

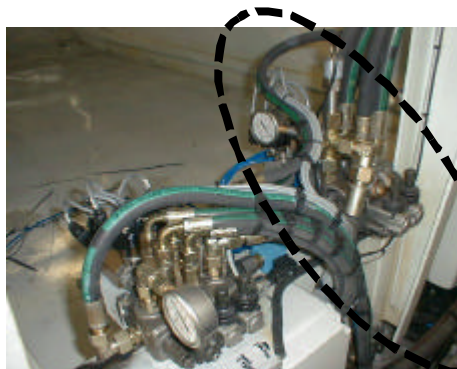

**VISTA FRONTE**  
**FRONT VIEW**

**VISTA RETRO**  
**REAR VIEW**

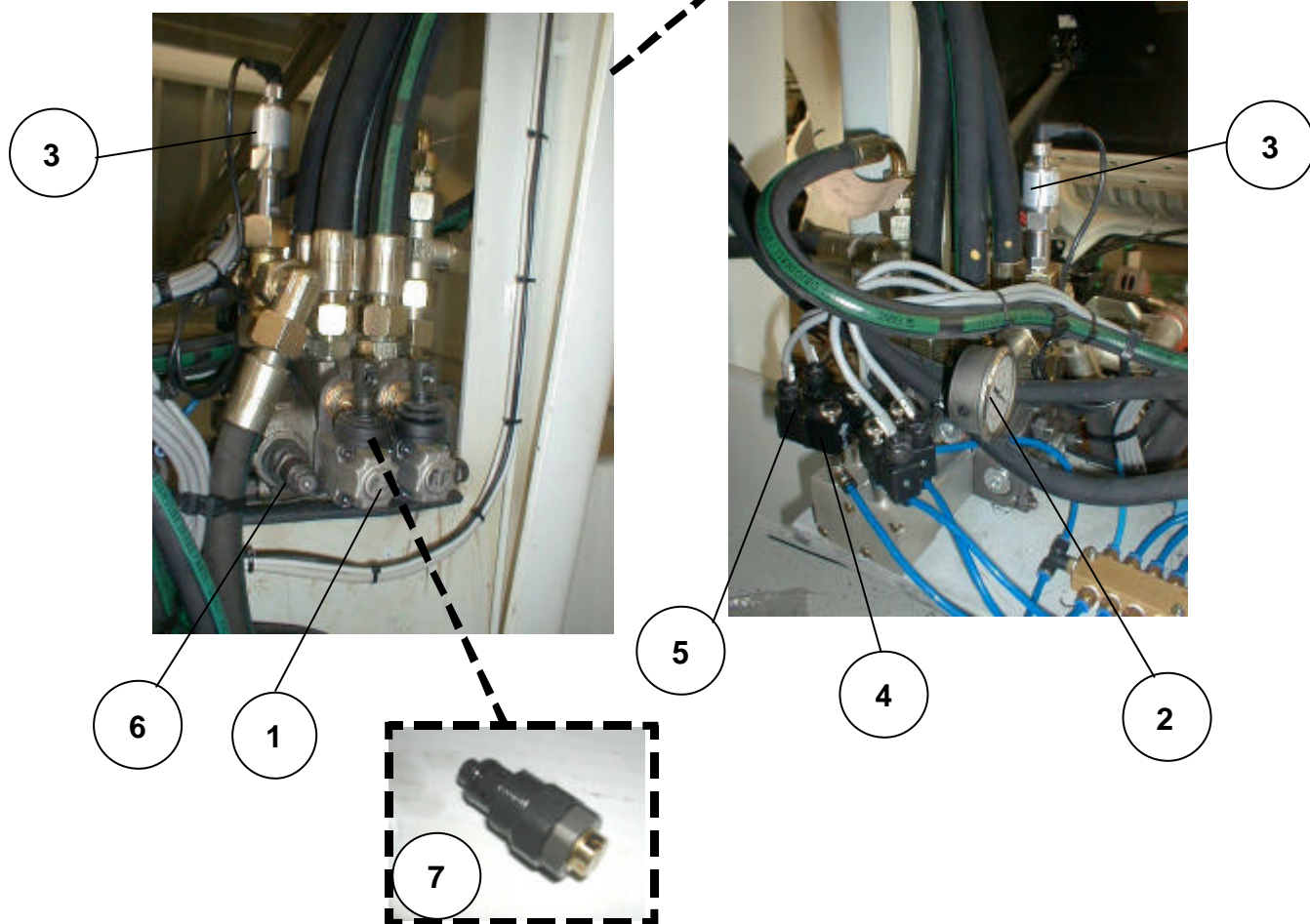

|     |   |             |                     |                   |   |  |
|-----|---|-------------|---------------------|-------------------|---|--|
| T16 | 1 | 04010001362 | DISTRIBUTORE        | OIL DISTRIBUTOR   | 1 |  |
| T16 | 2 | 04110001006 | MANOMETRO           | MANOMETER         | 1 |  |
| T16 | 3 | 04130001016 | PRESSOSTATO         | PRESSURE SWITCH   | 1 |  |
| T16 | 4 | 04090001019 | ELETTRIVALVOLA 24 V | SOLENOID 24 V     | 4 |  |
| T16 | 5 | 06050001012 | CONNETTORE          | CONNECTOR         | 4 |  |
| T16 | 6 | 04040001707 | VALVOLA DI MASSIMA  | MAX VALVE         | 1 |  |
| T16 | 7 | 04010001543 | VALVOLA ANTIURTO    | SHOCK PROOF VALVE | 1 |  |

## DISTRIBUTORE SERVIZI OIL DISTRIBUTOR FOR SERVICES

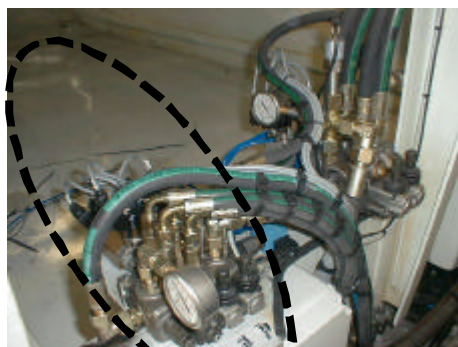

**VISTA FRONTE**  
**FRONT VIEW**

**VISTA RETRO**  
**REAR VIEW**

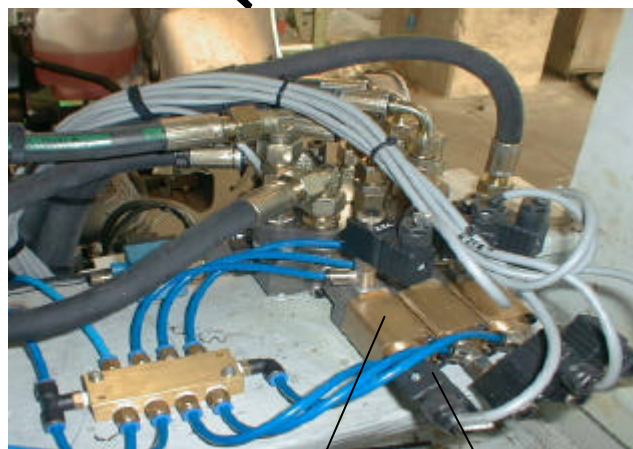
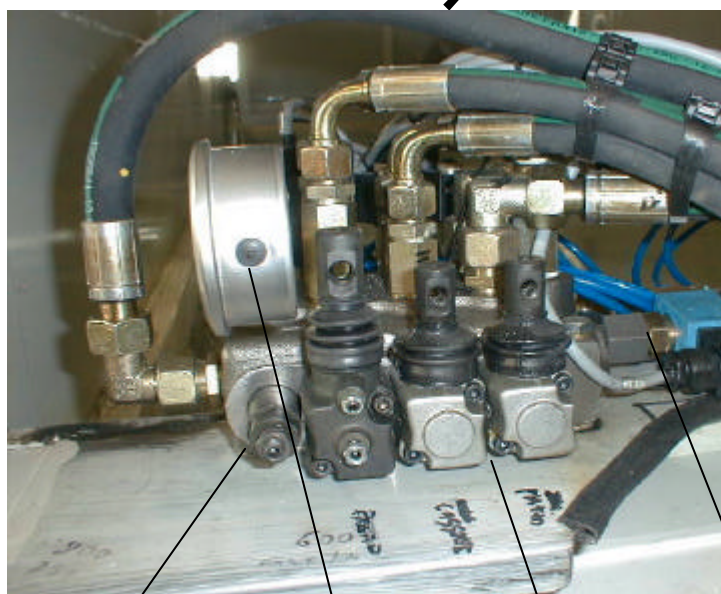

9

2

1

3

4

5

8

6

7

| TAV | POS | CODICE      | DESCRIZIONE               | DESCRIPTION                | Q.TY | NOTE              |
|-----|-----|-------------|---------------------------|----------------------------|------|-------------------|
| T17 | 1   | 04010001306 | DISTRIBUTORE SERVIZI      | OIL DISTRIBUTOR SERVICES   | 1    |                   |
| T17 | 2   | 04110001006 | MANOMETRO                 | MANOMETER                  | 1    |                   |
| T17 | 3   | 04090001007 | VALVOLA BYPASS            | BYPASS VALVE               | 1    |                   |
| T17 | 4   | 04040001625 | ELETTROVALVOLA 24 V       | SOLENOID 24 V              | 1    |                   |
| T17 | 5   | 05080001003 | CONNETTORE VALV- BY-PASS  | BY-PASS VALVE CONNECTOR    | 1    |                   |
| T17 | 6   | 04090001019 | ELETTROVALVOLA PNEUM. 24V | ELECTOVALVE PNEUMATIC 24 V | 6    |                   |
| T17 | 7   | 06050001012 | CONNETTORE                | CONNECTOR                  | 6    |                   |
| T17 | 8   | 04010001479 | COMANDO PNEUMATICO        | PNEUMATIC CONTROL          | 3    | COMPLETO-COMplete |
| T17 | 9   | 04040001708 | VALVOLA DI MASSIMA        | MAX VALVE                  | 1    |                   |

**GRUPPO VALVOLA CONTROPRESSIONE SU DISTRIBUTORE SERVIZI**  
**VALVES FOR RESISTOR PRESSURE ON SERVICES DISTRIBUTOR**

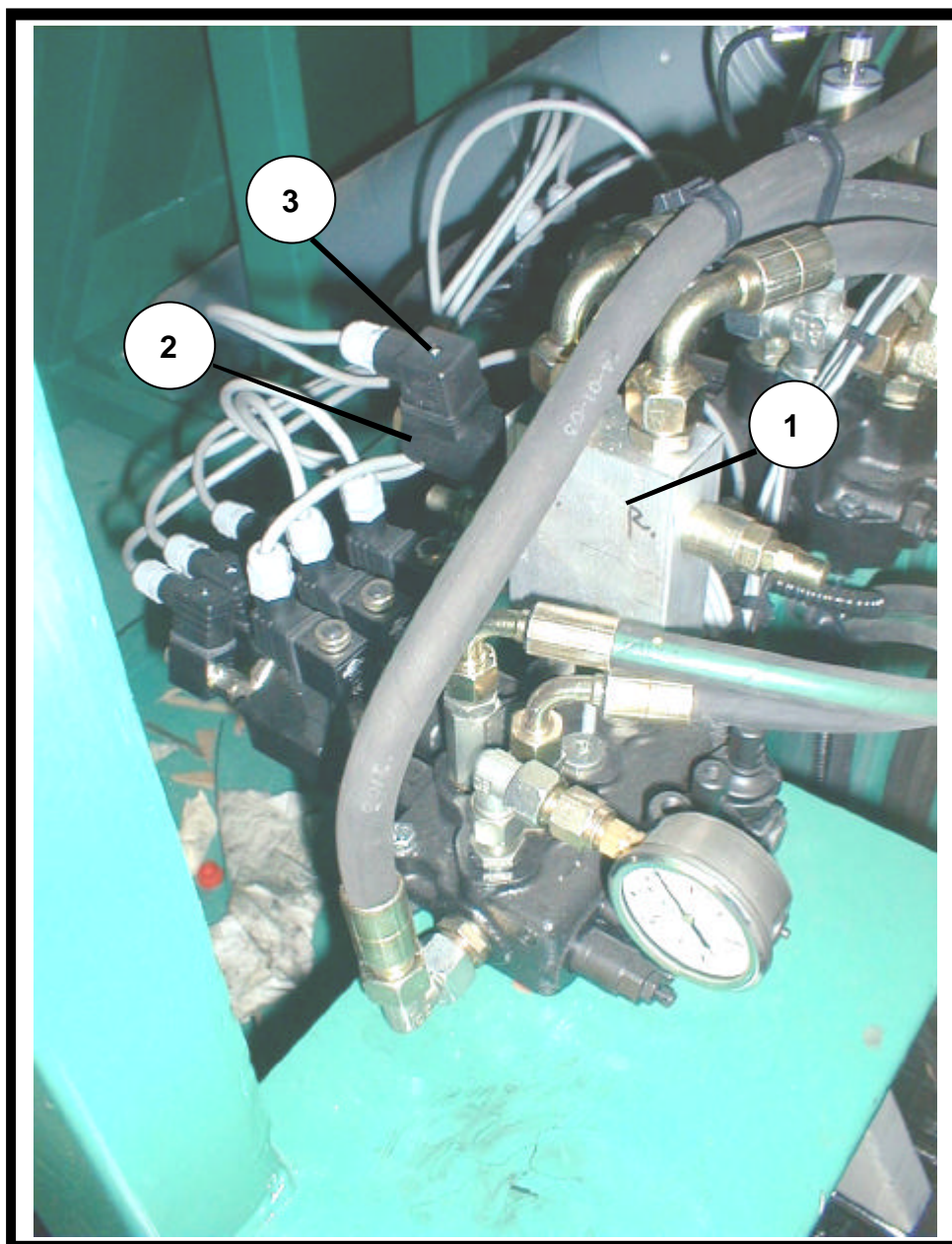

| TAV  | POS | CODICE      | DESCRIZIONE    | DESCRIPTION   | Q.TY | NOTE |
|------|-----|-------------|----------------|---------------|------|------|
| T17B | 1   | 04040001636 | VALVOLA        | VALVE         | 1    |      |
| T17B | 2   | 04040001217 | SOLENOIDE 24 V | SOLENOID 24 V | 1    |      |
| T17B | 3   | 05080001003 | CONNETTORE     | CONNECTOR     | 1    |      |

**PNEUMATICA**

**PNEUMATIC**



## COMPONENTI PNEUMATICI PNEUMATIC COMPONENTS

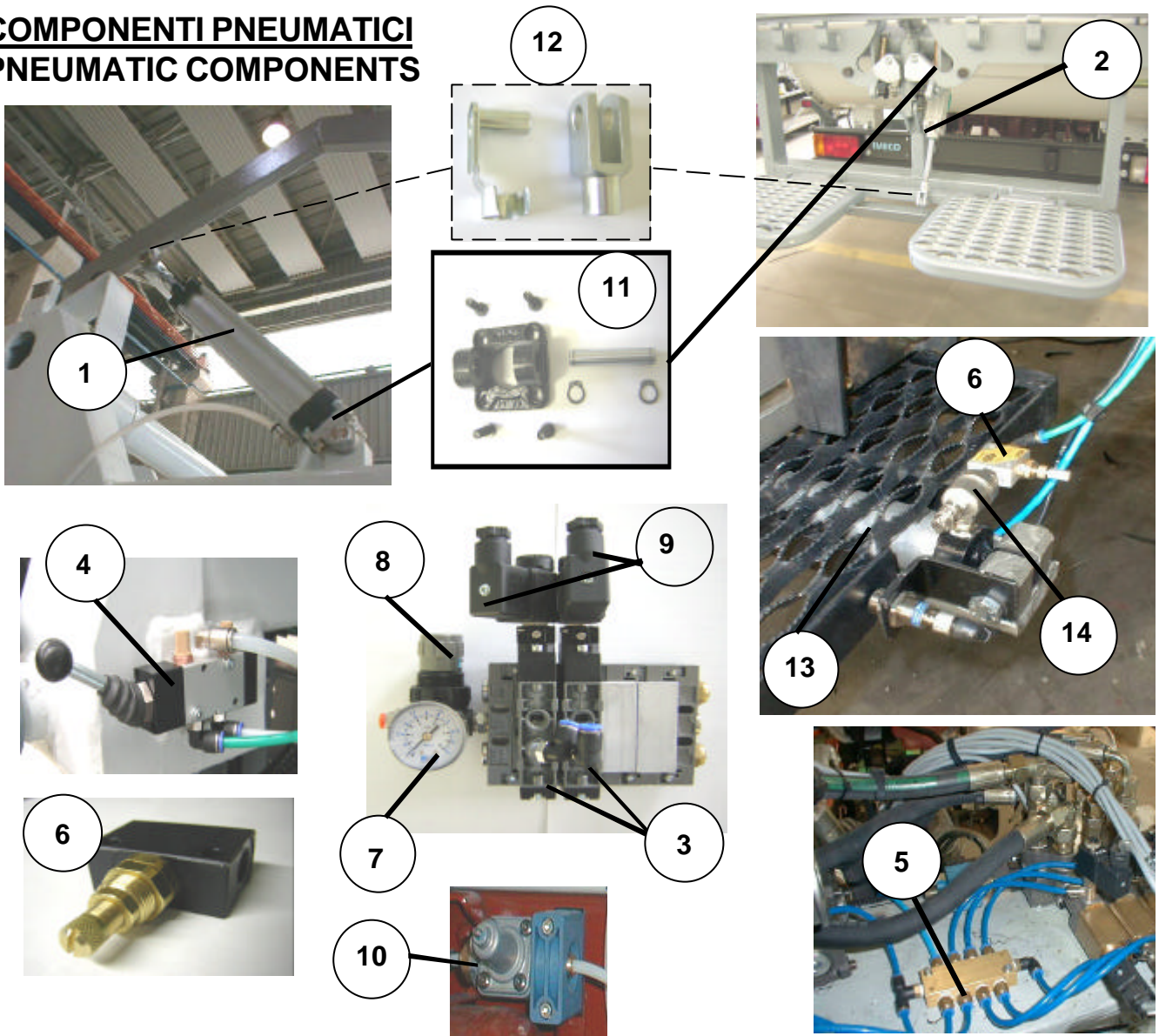

| TAV | POS | CODICE      | DESCRIZIONE                  | DESCRIPTION                  | Q.TY | NOTE                             |
|-----|-----|-------------|------------------------------|------------------------------|------|----------------------------------|
| T19 | 1   | 06010001076 | CILINDRO APRICOPERCHI        | CYLINDER FOR COVER BIN BAR   | 1    | Corsa-course 200mm               |
| T19 | 1   | 04120002540 | SERIE GUARNIZIONI CILINDRO   | SEAL KIT FOR CYLINDER        | 1    |                                  |
| T19 | 2   | 06010001214 | CILINDRO PEDANA -A ROTAZIONE | CYLINDER - ROTATION PLATFORM | 1    | Corsa-course 100mm               |
| T19 | 2   | 04120002596 | SERIE GUARNIZIONI CILINDRO   | SEAL KIT FOR CYLINDER        | 1    |                                  |
| T19 | 3   | 06050001019 | ELETTOVALVOLE 24 V           | SOLENOID 24 V                | 2    |                                  |
| T19 | 4   | 06040001055 | INTERRUTTORE PNEUMATICO      | PNEUMATIC SWITCH             | 1    | COMPLETO-COMLETE                 |
|     |     | 06050001034 | SILENZIATORE                 | SILENT                       | 2    |                                  |
| T19 | 5   | 06040001037 | BLOCCETTO PNEUMATICO         | PNEUMATIC BOX                | 1    |                                  |
| T19 | 6   | 06040001016 | REGOLATORE                   | REGULATOR                    | /    |                                  |
| T19 | 7   | 06100001003 | MANOMETRO                    | MANOMETER                    | 1    |                                  |
| T19 | 8   | 06080001005 | REGOLATORE FLUSSO            | REGULATOR                    | 1    |                                  |
| T19 | 9   | 06050001012 | CONNETTORE                   | CONNECTOR                    | 2    |                                  |
| T19 | 10  | 06040001036 | VALVOLA PRESA ARIA           | REGULATOR VALVE              | 1    | 6 Bar                            |
| T19 | 10  | 06040001035 | VALVOLA PRESA ARIA           | REGULATOR VALVE              |      | 8,5 Bar                          |
| T19 | 11  | 08270001255 | KIT CERNIERA                 | KIT HINGE                    | /    |                                  |
| T19 | 12  | 06010001039 | FORCELLA                     | FORK                         | /    | completa-complete                |
| T19 | 13  | 06010001007 | CILINDRO PEDANE              | CYLINDER FOR PLATFORM        | 2    | Tipo scorrimento<br>Sliding type |
| T19 | 14  | 04010001079 | REGOLATORE                   | REGULATOR                    | 2    |                                  |
|     |     | 06020001061 | VALVOLA SCARICO              | DISCHARGE VALVE              | 2    |                                  |



**ELETTRICA**

**ELECTRIC**

**IN CABINA**  
**IN TO CAB**

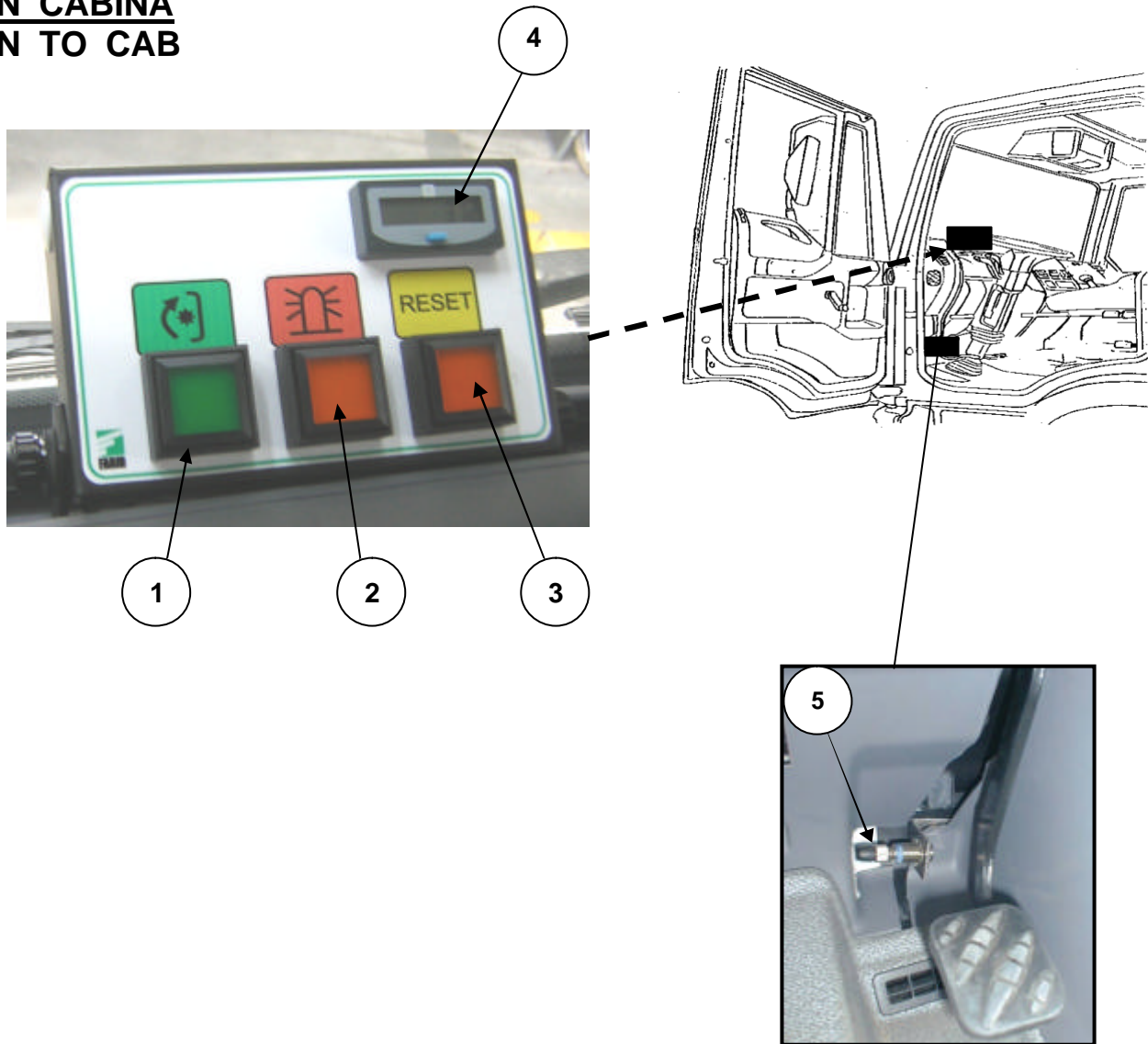

| TAV. | POS | CODICE/CODE        | DESCRIZIONE                  | DESCRIPTION               | Q.TY | NOTE                            |
|------|-----|--------------------|------------------------------|---------------------------|------|---------------------------------|
| T20  |     | <b>05010001337</b> | SINOTTICO COMPLETO -<br>24 V | SINOPTIC COMPLETE<br>24 V | 1    | CON CONTAORE<br>WITH HOUR METER |
| T20  | 1   | <b>05010001386</b> | PULSANTE VERDE               | GREEN BUTTON              | 1    | COMPLETO-COMPLETE               |
| T20  | 2   | <b>05010001387</b> | INTERRUTTORE ARANCIO         | ORANGE SWITCH             | 1    | COMPLETO-COMPLETE               |
| T20  | 3   | <b>05010001389</b> | PULSANTE ARANCIO             | ORANGE BUTTON             | 1    | COMPLETO-COMPLETE               |
| T20  | 4   | <b>05180001040</b> | CONTAORE                     | HOUR METER                | 1    |                                 |
| T20  | 7   | <b>05050001027</b> | SENSORE SU FRIZIONE          | SENSOR                    | 1    |                                 |
|      |     | <b>05080001050</b> | CAVO                         | CABLE                     | 1    |                                 |

PAGINA 1 / 2  
SHEET

## SINOTTICO SINOPTIC

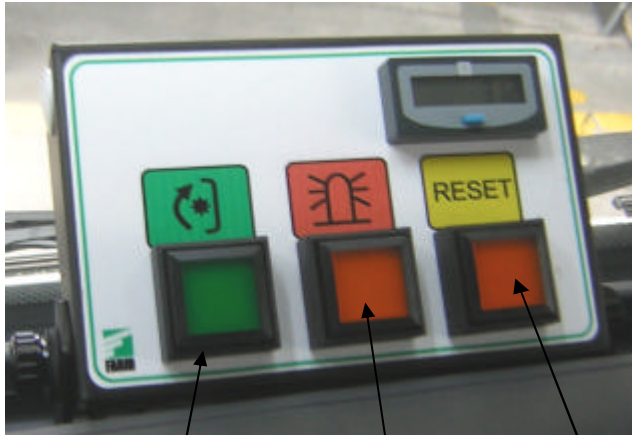

1

2

3

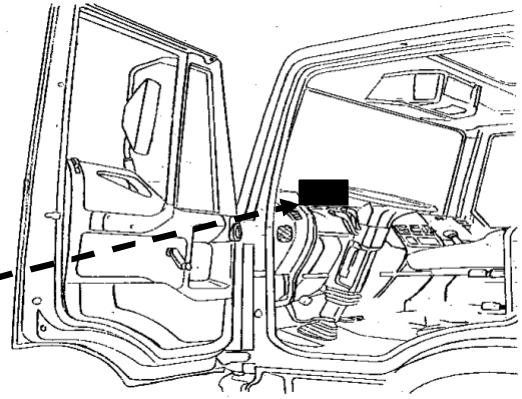

| TAV. | POS | CODICE/CODE | DESCRIZIONE                                       | DESCRIPTION                            | Q.TY | NOTE |
|------|-----|-------------|---|--|------|------|
| T20  | 1   | 05010001381 | PULSANTE - CORPO                                  | BODY-BUTTON                            | 1    |      |
|      |     | 05010001405 | GEMMA QUADRA VERDE                                | GREEN GEM                              | 1    |      |
| T20  | 2   | 05010001324 | INTERRUTTORE - CORPO                              | BODY-SWITCH                            | 1    |      |
|      |     | 05010001404 | GEMMA QUADRA ARANCIO                              | ORANGE GEM                             | 1    |      |
| T20  | 3   | 05010001381 | PULSANTE - CORPO                                  | BODY-BUTTON                            | 1    |      |
|      |     | 05010001404 | GEMMA QUADRA ARANCIO                              | ORANGE GEM                             | 1    |      |
| T20  |     | 05120001139 | LAMPADINA PER<br>PULSANTE / INTERRUTT.<br>24 VOLT | LAMP FOR<br>BUTTON / SWITCH<br>24 VOLT | 1    |      |

PAGINA 2 / 2  
SHEET

**SCATOLA ELETTRICA PRINCIPALE  
ELECTRIC BOX**

**\* PER PROGRAMMARE LA CPU ,  
E' NECESSARIO IN FASE  
D'ORDINE COMUNICARE A FARID  
IL NUMERO DI MATRICOLA  
DELL'ATTREZZATURA**

---

**\* FOR CPU PROGRAMMING,  
WHEN ORDERING PLEASE  
COMMUNICATE TO FARID THE  
SERIAL NUMBER OF THE  
EQUIPMENT**

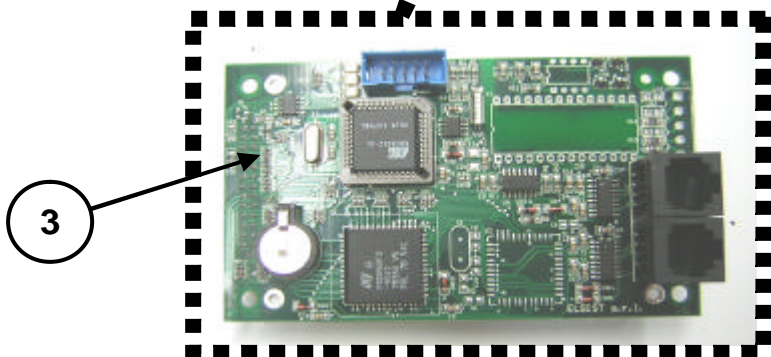
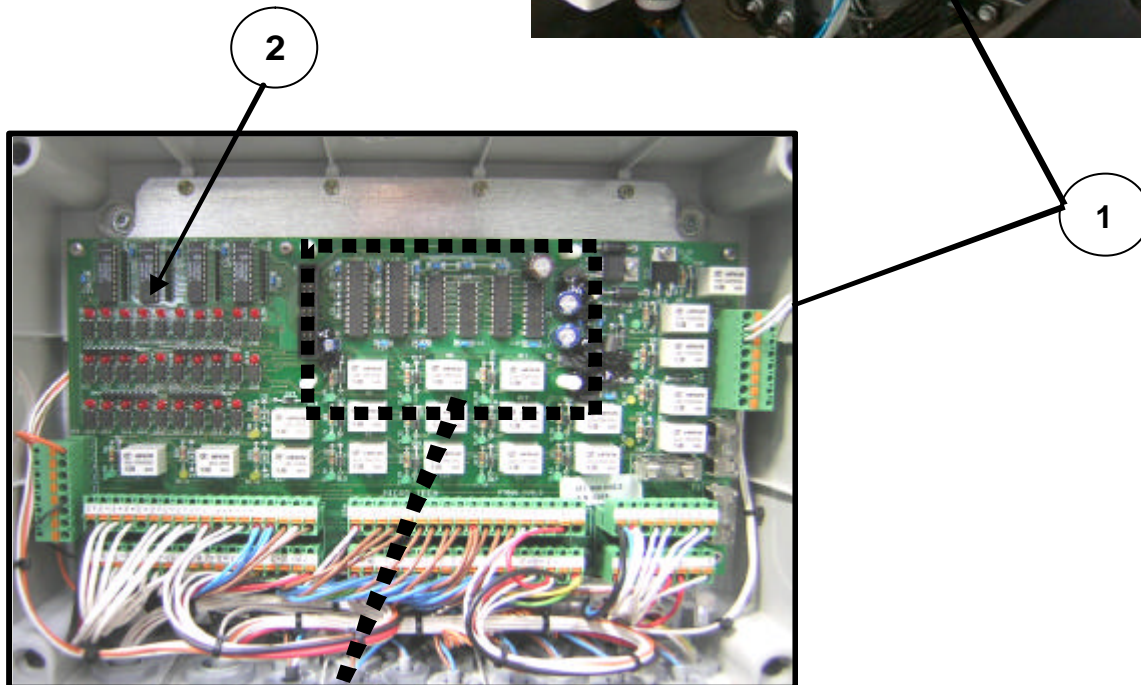

| TAV | POS | CODICE      | DESCRIZIONE                        | DESCRIPTION           | Q.TY | NOTE |
|-----|-----|-------------|------------------------------------|-----------------------|------|------|
| T21 | 1   | 05090001416 | SCATOLA EL. PRINCIPALE<br>COMPLETA | ELECTRIC BOX COMPLETE | 1    |      |
| T21 | 2   | 05030001094 | SCHEDA ELETTRONICA                 | ELECTRONIC CARD       | 1    |      |
| T21 | 3   | 02100002076 | CPU - PROGRAMMATA                  | CPU - PROGRAMMED      | 1    | *    |

**SENSORE SU PARATIA ESPULSIONE**  
**SENSOR ON EJECTION PLATE**

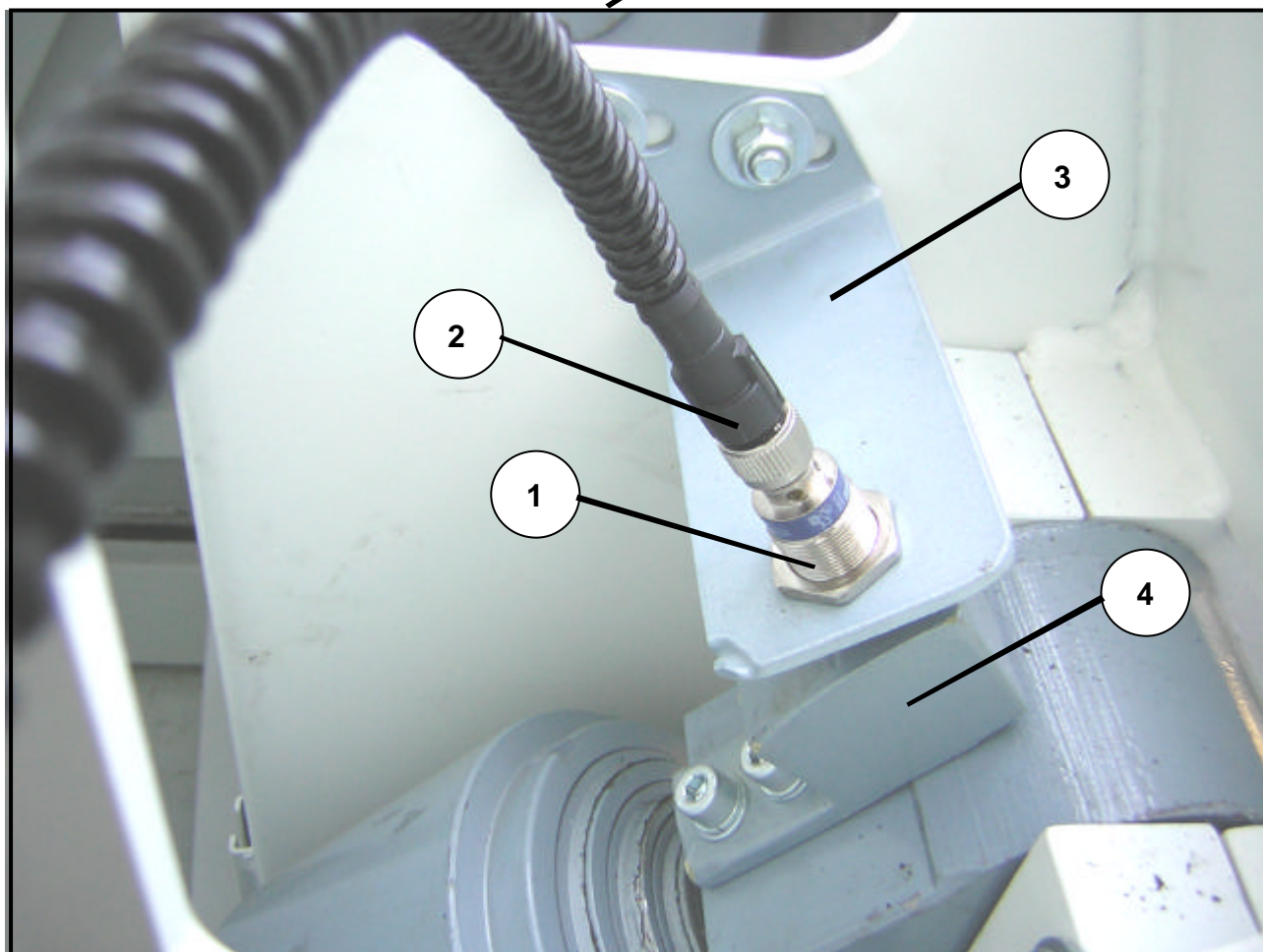
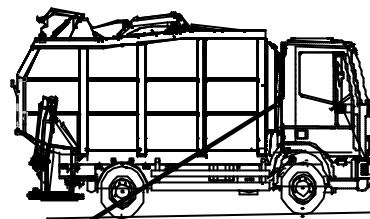

| TAV  | POS | CODICE      | DESCRIZIONE             | DESCRIPTION        | Q.TY | NOTE |
|------|-----|-------------|-------------------------|--------------------|------|------|
| T22A | 1   | 05050001027 | SENSORE                 | SENSOR             | 1    |      |
| T22A | 2   | 05080001042 | CAVO                    | CABLE              | 1    |      |
| T22A | 3   | 03240001545 | STAFFA SUPPORTO SENSORE | SUPPORT FOR SENSOR | 1    |      |
| T22A | 4   | 03240001546 | CAMMA                   | CAM                | 1    |      |



## SENSORE CHIUSURA PETTINE SENSOR FOR LOCK MOVING FRAME

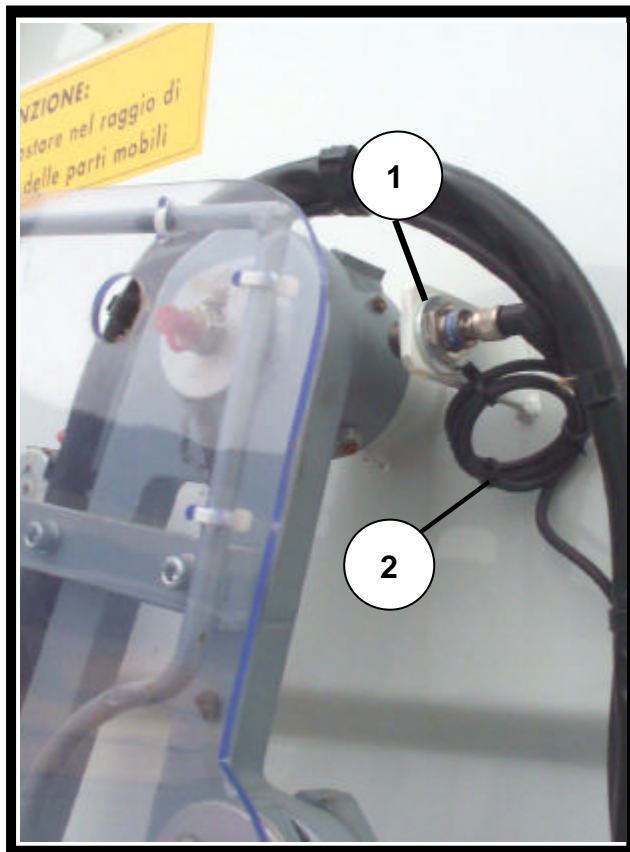
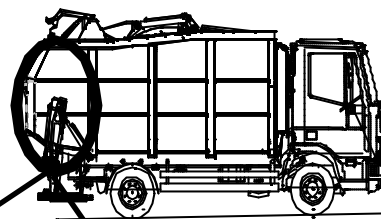

**STANDARD**

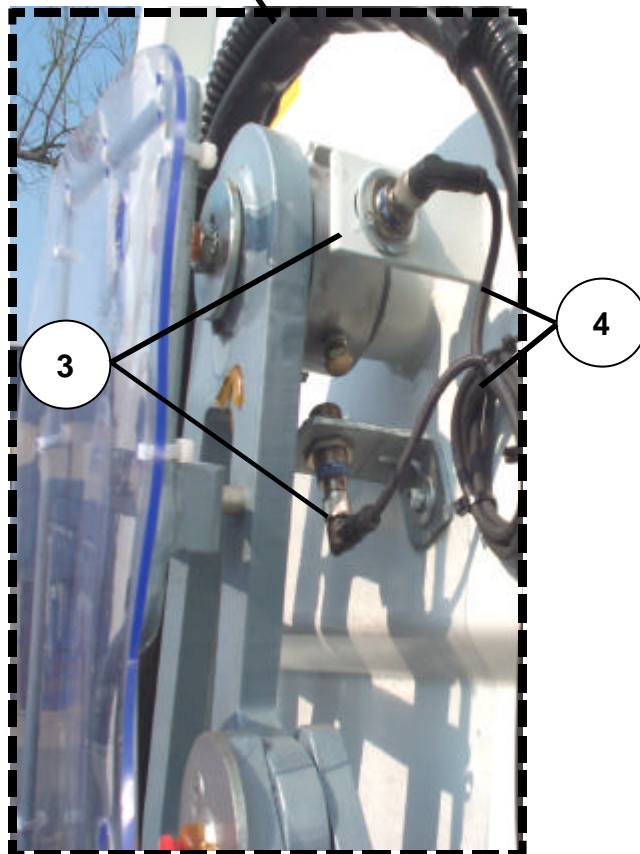

**CON PEDANE / AVC AUTOMATICO  
WITH PLATFORMS / AUTOMATIC BIN LIFT**

| TAV | POS | CODICE      | DESCRIZIONE | DESCRIPTION | Q.TY | NOTE |
|-----|-----|-------------|-------------|-------------|------|------|
| T23 | 1   | 05050001027 | SENSORE     | SENSOR      | 1    |      |
| T23 | 2   | 05080001050 | CAVO        | CABLE       | 1    |      |

|     |   |             |         |        |   |  |
|-----|---|-------------|---------|--------|---|--|
| T23 | 3 | 05050001027 | SENSORE | SENSOR | 2 |  |
| T23 | 4 | 05080001050 | CAVO    | CABLE  | 2 |  |

## SENSORE SPONDINA POSTERIORE REAR FLAP SENSOR

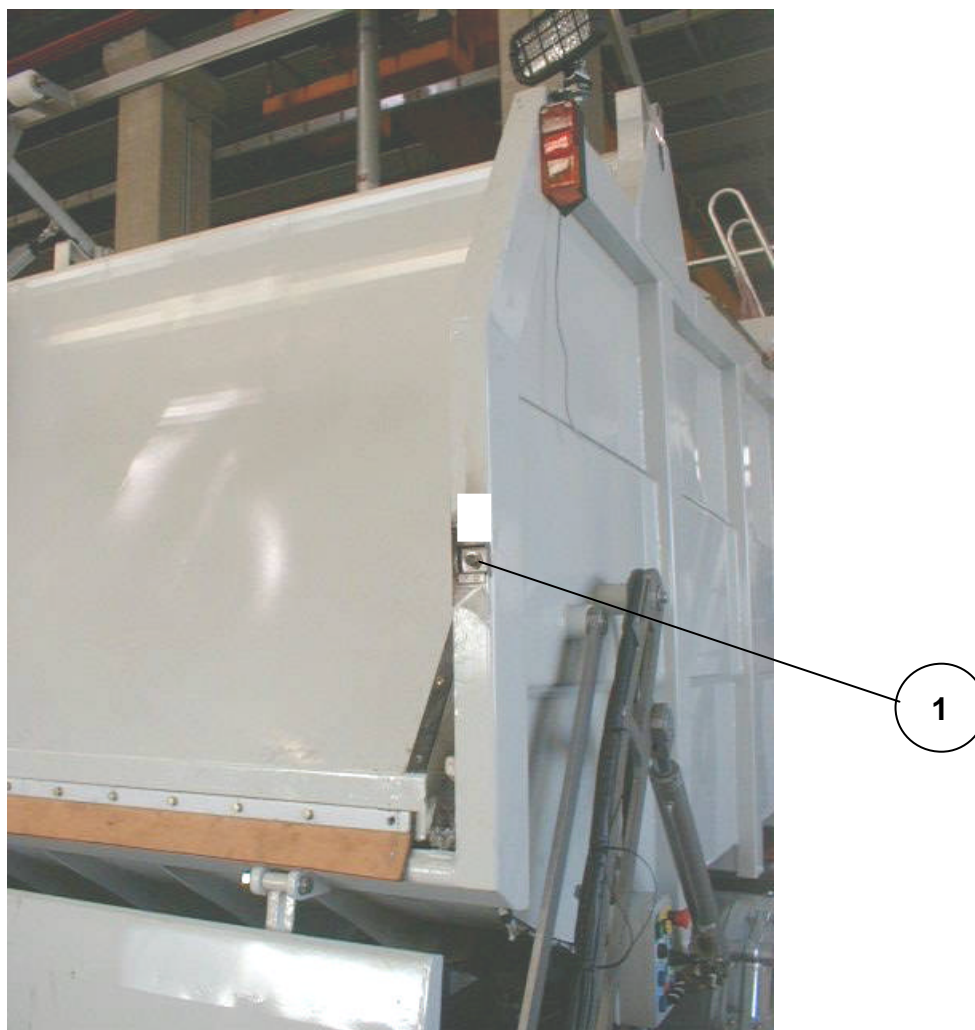

| TAV | POS | CODICE             | DESCRIZIONE | DESCRIPTION | Q.TY | NOTE |
|-----|-----|--------------------|-------------|-------------|------|------|
| T24 | 1   | <b>05050001027</b> | SENSORE     | SENSOR      | 1    |      |
| T24 | 1   | <b>05080001050</b> | CAVO        | CABLE       | 1    |      |
| T24 | 1   | <b>08260001197</b> | SUPPORTO    | SUPPORT     | 1    |      |

## SENSORE CILINDRO SLITTA SLIDE CILYNDER SENSOR

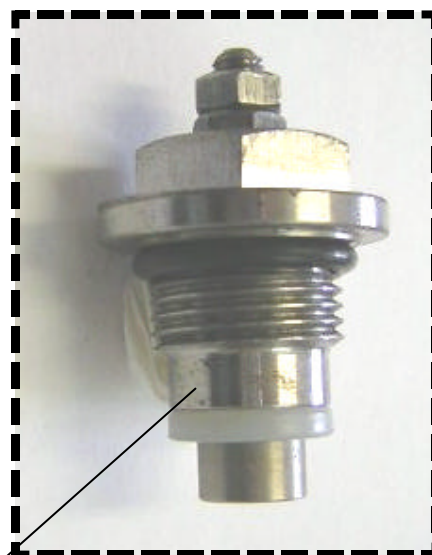
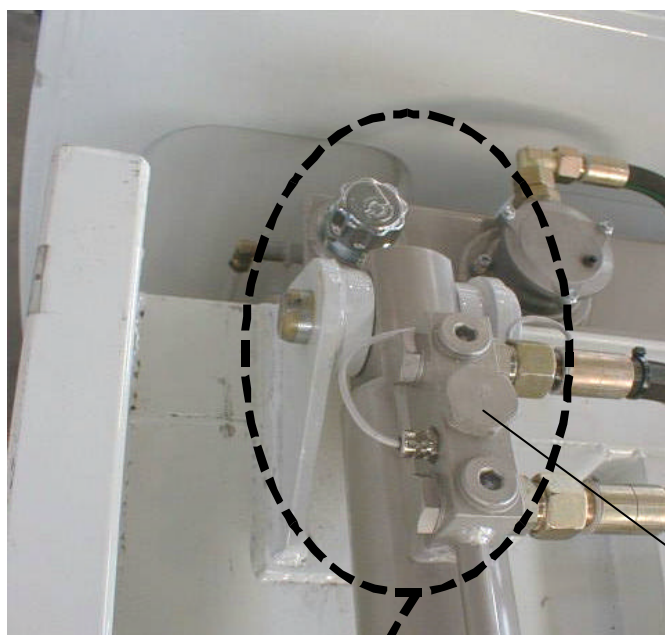

1

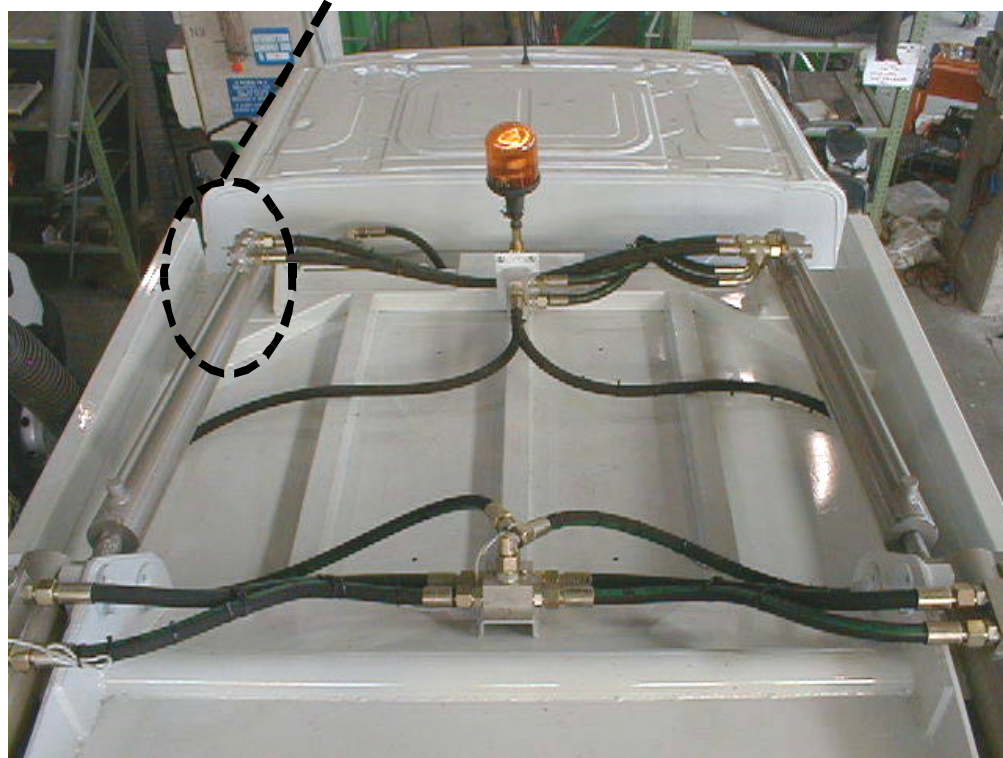

| TAV | POS | CODICE      | DESCRIZIONE | DESCRIPTION | Q.TY | NOTE |
|-----|-----|-------------|-------------|-------------|------|------|
| T26 | 1   | 05050001220 | SENSORE     | SENSOR      | 1    |      |



**SENSORE CILINDRO PALA**  
**PACKER PLATE CILYNDER SENSOR**

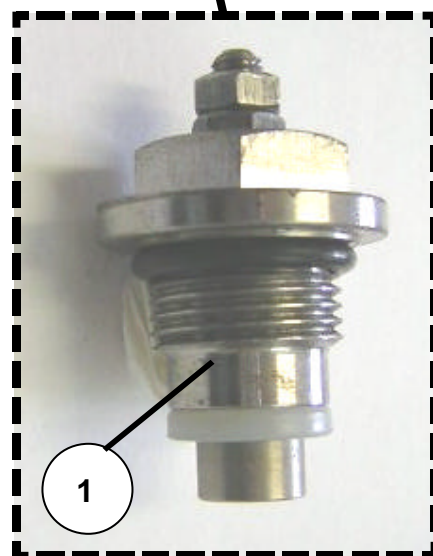
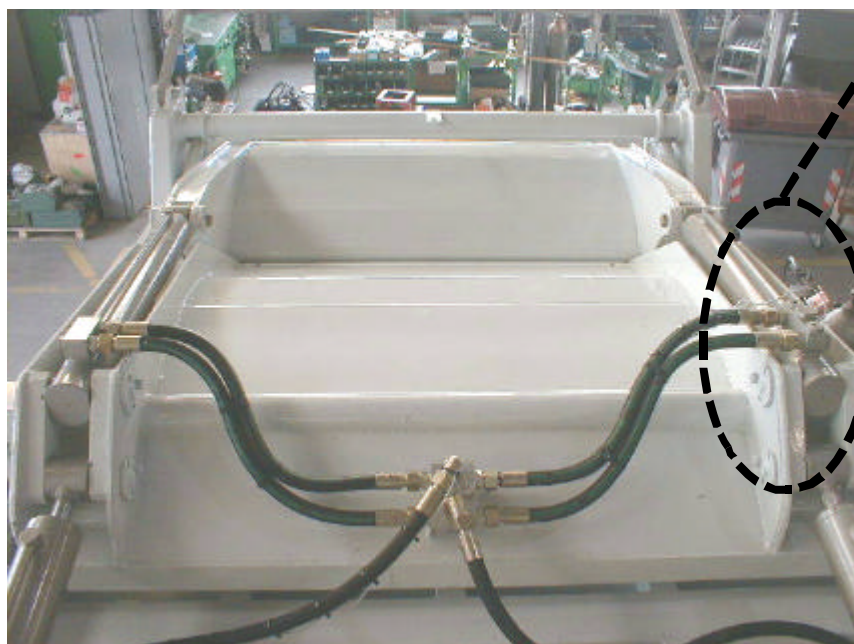
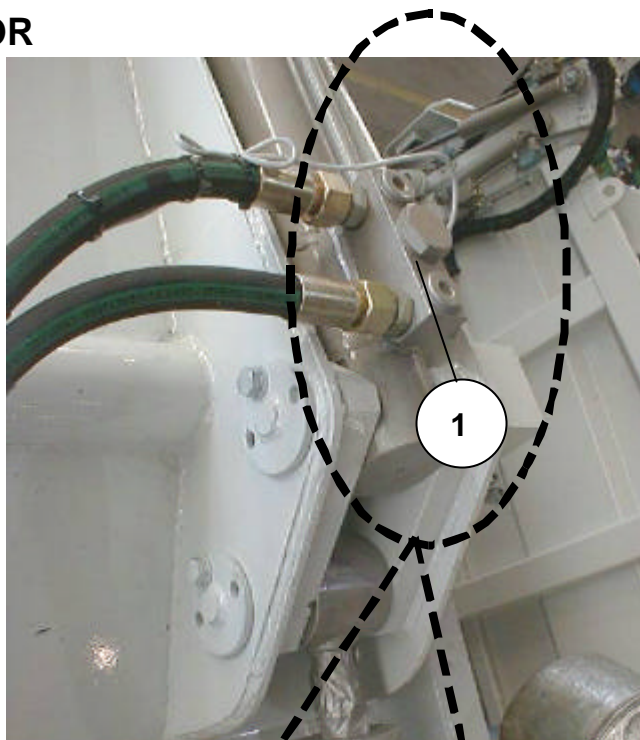

| TAV | POS | CODICE      | DESCRIZIONE | DESCRIPTION | Q.TY | NOTE |
|-----|-----|-------------|-------------|-------------|------|------|
| T27 | 1   | 05050001220 | SENSORE     | SENSOR      | 1    |      |

## PULSANTIERA POSTERIORE DESTRA CONTROL BOX SIDE RIGHT ( REAR )

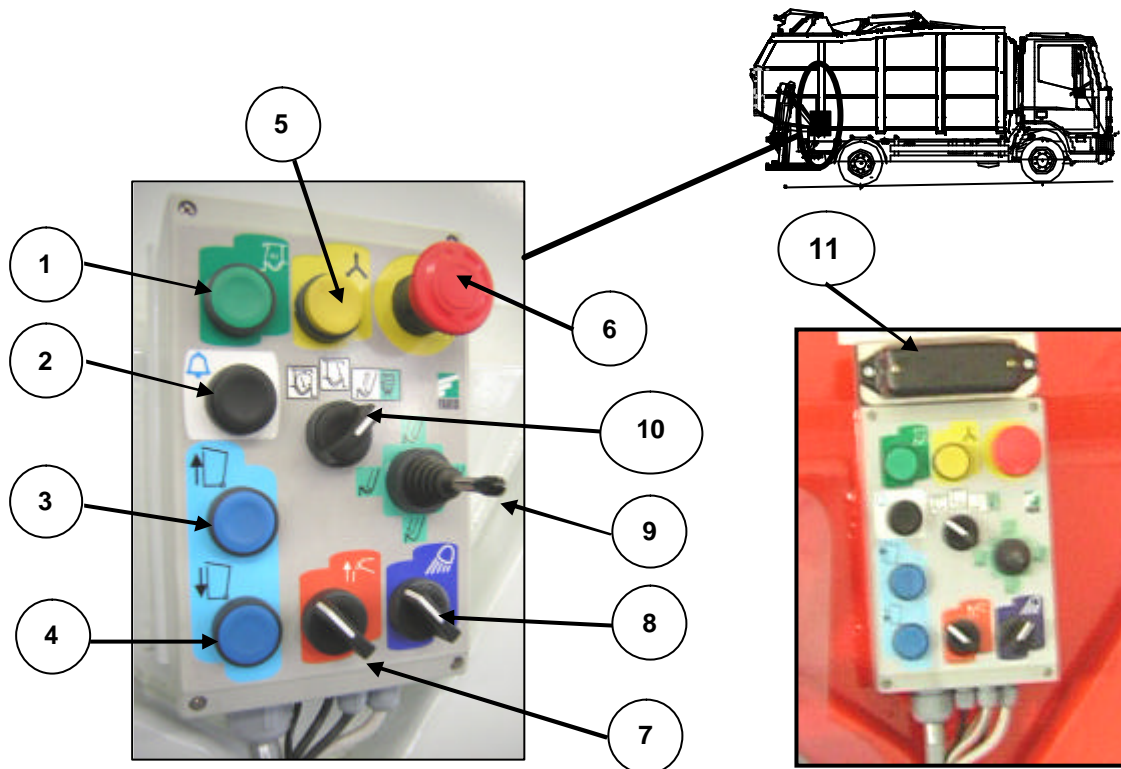

| TAV. | POS | CODICE      | DESCRIZIONE                  | DESCRIPTION                        | Q.TY | NOTE                |
|------|-----|-------------|------------------------------|------------------------------------|------|---------------------|
| T28  | 1   | 05020001273 | PULSANTE VERDE               | GREEN BUTTON                       | 1    |                     |
|      |     | 05020001043 | CORPO E CONTATTO NO          | BODY AND CONTACT NO                | 1    |                     |
| T28  | 2   | 05020001275 | PULSANTE NERO                | BLACK BUTTON                       | 1    |                     |
|      |     | 05020001043 | CORPO E CONTATTO NO          | BODY AND CONTACT NO                | 1    |                     |
| T28  | 3   | 05140001238 | PULSANTE BLU                 | BLU BUTTON                         | 1    |                     |
|      |     | 05020001043 | CORPO E CONTATTO NO          | BODY AND CONTACT NO                | 1    |                     |
| T28  | 4   | 05140001238 | PULSANTE BLU                 | BLU BUTTON                         | 1    |                     |
|      |     | 05020001043 | CORPO E CONTATTO NO          | BODY AND CONTACT NO                | 1    |                     |
| T28  | 5   | 05020001271 | PULSANTE GIALLO              | YELLOW BUTTON                      | 1    |                     |
|      |     | 05020001043 | CORPO E CONTATTO NO          | BODY AND CONTACT NO                | 1    |                     |
| T28  | 6   | 05020001392 | PULSANTE ROSSO               | RED BUTTON                         | 1    | D = 40 mm           |
|      |     | 05020001357 | CORPO E CONTATTO NC          | BODY AND CONTACT NC                | 1    |                     |
| T28  | 7   | 05150001015 | SELETTORE                    | SELECTOR                           | 1    |                     |
|      |     | 05020001043 | CORPO E CONTATTO NO          | BODY AND CONTACT NO                | 1    |                     |
| T28  | 8   | 05150001015 | SELETTORE                    | SELECTOR                           | 1    |                     |
|      |     | 05020001043 | CORPO E CONTATTO NO          | BODY AND CONTACT NO                | 1    |                     |
| T28  | 9   | 05020001281 | MANIPOLATORE<br>CON CONTATTI | JOYSTIC -SELECTOR<br>WITH CONTACTS | 1    | COMPLETO - COMPLETE |
| T28  | 10  | 05150001065 | SELETTORE                    | SELECTOR                           | 1    |                     |
|      |     | 05020001043 | CORPO E CONTATTO NO          | BODY AND CONTACT NO                | 1    |                     |
|      |     | 05020001371 | CONTATTO NC                  | CONTACT NC                         | 2    |                     |
| T28  | 11  | 05060001165 | LUCE PULSANTIERA             | CONTROL BOX LIGHT                  | 1    | OPTIONAL            |
|      |     | 08260001209 | SUPPORTO                     | SUPPORT                            | 1    |                     |

|     |  |             |                      |                         |   |  |
|-----|--|-------------|----------------------|-------------------------|---|--|
| T28 |  | 05010001380 | PULSANTIERA COMPLETA | CONTROL BOX<br>COMPLETE | 1 |  |
|-----|--|-------------|----------------------|-------------------------|---|--|

## PULSANTIERA ANTERIORE DESTRA CONTROL BOX SIDE RIGHT (FRONT)

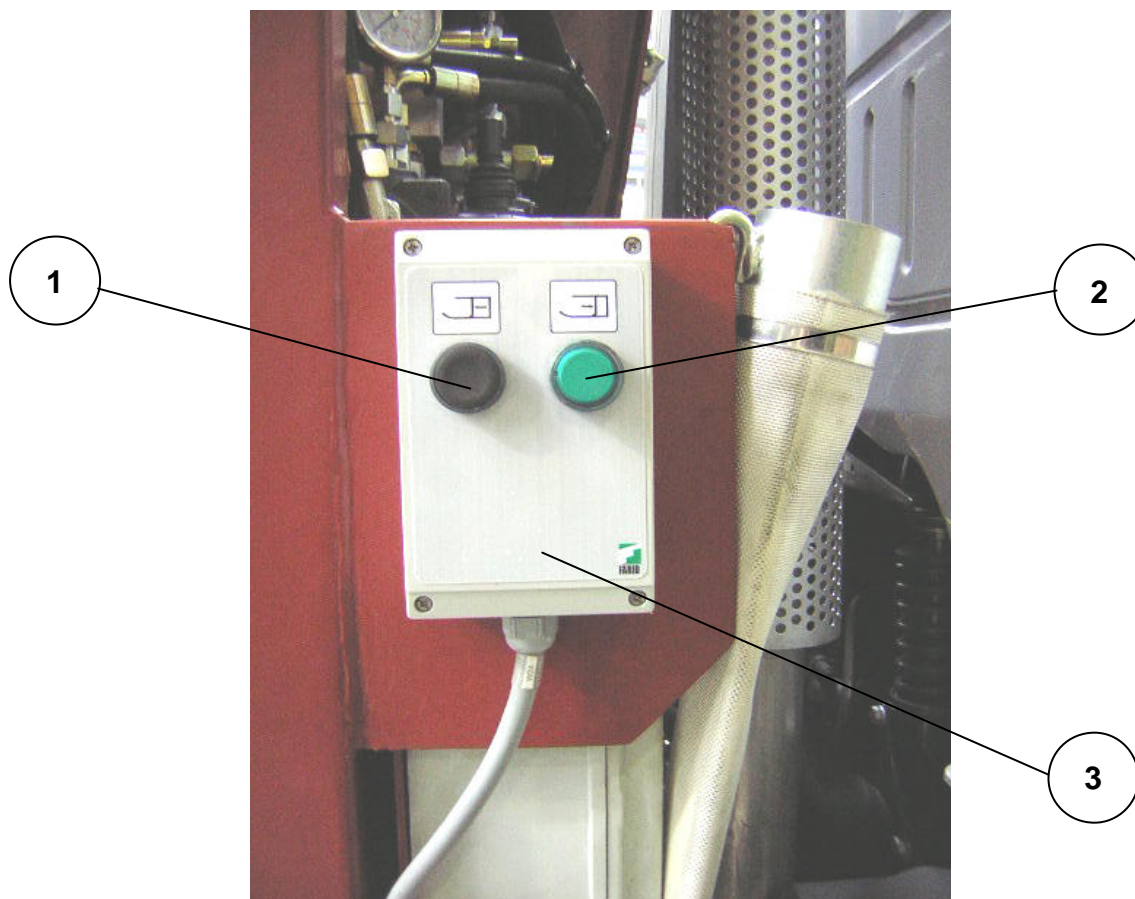

| TAV  | POS | CODICE      | DESCRIZIONE            | DESCRIPTION          | Q.TY | NOTE |
|------|-----|-------------|------------------------|----------------------|------|------|
| T29C | 1   | 05010001316 | PULSANTE NERO          | BLACK BUTTON         | 1    |      |
|      |     | 05020001043 | CORPO E CONTATTO NO    | BODY AND CONTACT NO  | 1    |      |
| T29C | 2   | 05020001390 | PULSANTE VERDE - CORPO | GREEN BUTTON - BODY  | 1    |      |
|      |     | 05020001043 | CORPO E CONTATTO NO    | BODY AND CONTACT NO  | 1    |      |
|      |     | 05020001509 | LED VERDE              | GREEN LED            | 1    |      |
| T29C | 3   | 05010001523 | PULSANTIERA COMPLETA   | CONTROL BOX COMPLETE | 1    |      |

### **NOTES :**

- LEFT AND RIGHT REFER TO THE VIEW FROM THE REAR , LOOKING IN THE TRAVEL DIRECTION

- FOR THE U.K. MARKET THESE PUSH-BUTTON PANEL ARE POSITIONED ON THE RIGHT-HAND SIDE OF THE EQUIPMENT

## PULSANTIERA POSTERIORE SINISTRA CONTROL BOX SIDE LEFT ( REAR )

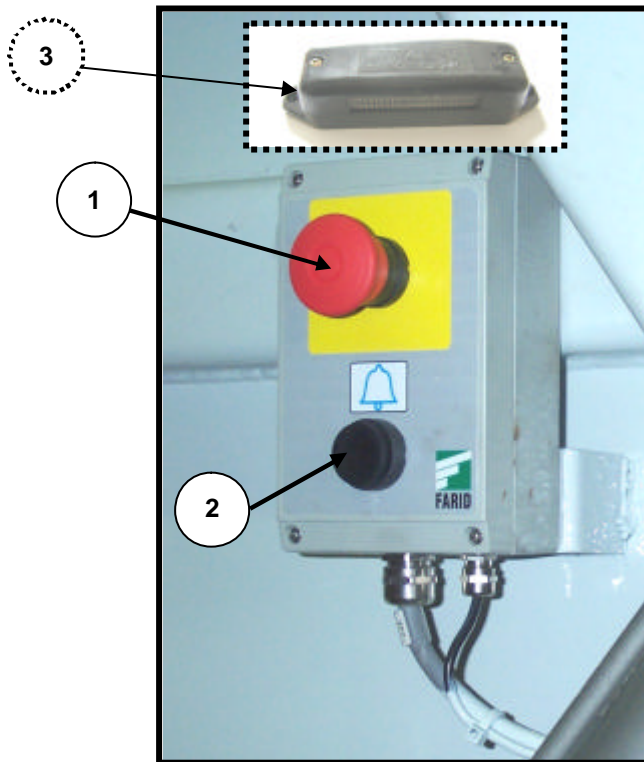
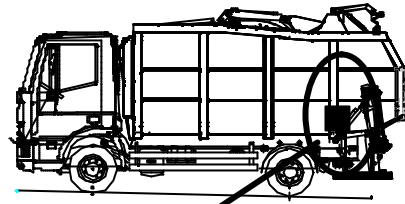

### NOTES :

LEFT AND RIGHT REFER TO THE VIEW FROM THE REAR , LOOKING IN THE TRAVEL DIRECTION

FOR THE U.K. MARKET THESE PUSH-BUTTON PANEL ARE POSITIONED ON THE RIGHT-HAND SIDE OF THE EQUIPMENT

| TAV. | POS | CODICE      | DESCRIZIONE   | DESCRIPTION          | Q.TY | NOTE      |
|------|-----|-------------|---|----------------------|------|-----------|
| T30  | 1   | 05020001392 | PULSANTE ROSSO                                      | RED BUTTON           | 1    | D = 40 mm |
|      |     | 05020001357 | CORPO E CONTATTO NC                                 | BODY AND CONTACT NC  | 1    |           |
| T30  | 2   | 05020001275 | PULSANTE NERO                                       | BLACK BUTTON         | 1    |           |
|      |     | 05020001043 | CORPO E CONTATTO NO                                 | BODY AND CONTACT NO  | 1    |           |
| T30  | 3   | 05060001165 | LUCE PULSANTIERA<br>LAMPADINA 24 V – 5W<br>SUPPORTO | LIGHT-CONTROL BOX    | 1    | OPTIONAL  |
|      |     | 05120001064 |   | LAMP 24 V – 5W       | 1    |           |
|      |     | 08260001210 |   | SUPPORT              | 1    |           |
| T30  |     | 05010001174 | PULSANTIERA COMPLETA                                | CONTROL BOX COMPLETE | 1    |           |



## ACCESSORI ELETTRICI ELECTRIC ACCESSORIES

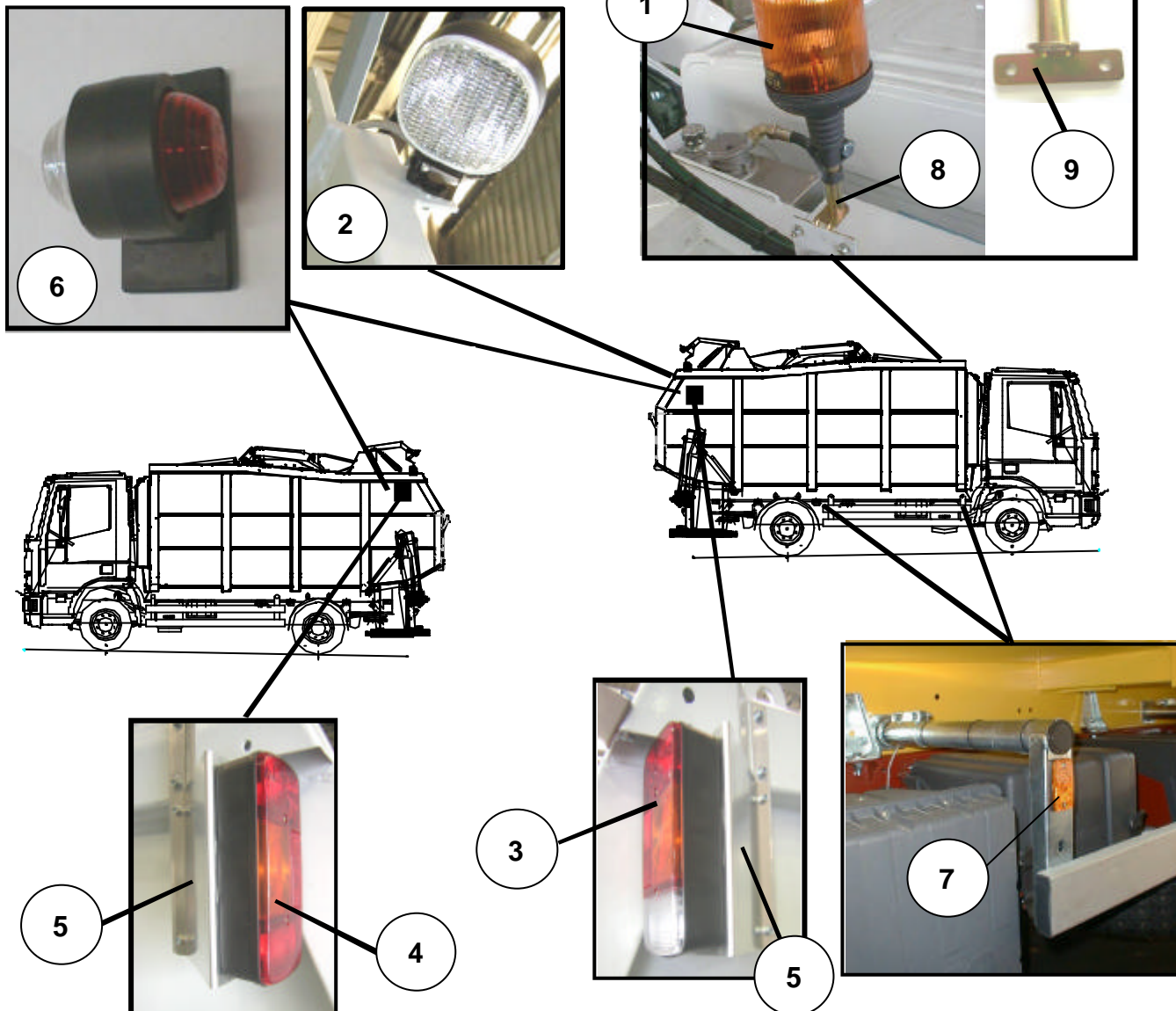

| TAV | POS | CODICE      | DESCRIZIONE                 | DESCRIPTION                 | Q.TY | NOTE              |
|-----|-----|-------------|-----------------------------|-----------------------------|------|-------------------|
| T31 | 1   | 05060001256 | FARO ROTANTE 24 V           | ROTATION LAMP 24 V          | /    | STANDARD          |
| T31 | 1   | 05120001076 | LAMPADINA 24 V-70W          | LAMP 24 V-70W               | /    |                   |
| T31 | 1   | 05060001276 | FARO FLASH 24 V-COMPLETO    | FLASH LAMP 24 V - COMPLETE  | /    | OPTIONAL          |
| T31 | 2   | 05060001261 | FARO BIANCO - COMPLETO      | WHITE LAMP - COMPLETE       | /    |                   |
| T31 | 2   | 05120001066 | LAMPADINA 24 V- 21W         | LAMP 24 V- 21W              | /    |                   |
| T31 | 2   | 05120001069 | LAMPADINA 24 V- 70W         | LAMP 24 V- 70W              | /    |                   |
| T31 | 3   | 05060001136 | LUCE RIPETIZ. DESTRA        | RIGHT LAMP                  | 1    | COMPLETA-COMplete |
| T31 | 3   | 05060001137 | COPERTURE IN PLASTICA       | PLASTIC COVER               | 1    |                   |
| T31 | 4   | 05060001138 | LUCE RIPETIZ. SINISTRA      | LEFT LAMP                   | 1    | COMPLETA-COMplete |
| T31 | 4   | 05060001139 | COPERTURE IN PLASTICA       | PLASTIC COVER               | 1    |                   |
| T31 | 3-4 | 05120001065 | LAMPADINE 24 V- 5/21W       | LAMPS 24 V- 5/21W           | 2    |                   |
| T31 | 3-4 | 05120001066 | LAMPADINA 24 V- 21W         | LAMP 24 V- 21W              | 2    |                   |
| T31 | 5   | 08260001264 | SUPPORTO                    | SUPPORT                     | 2    |                   |
| T31 | 6   | 05060001164 | LUCI INGOMBRO               | LIGHT                       | 2    |                   |
| T31 | 7   | 05060001206 | CATADIOTRO                  | REFLECTING                  | /    |                   |
| T31 | 7   | 05060001207 | LAMPADINA 24 V              | LAMP 24 V                   | /    |                   |
| T31 | 7   | 08260001158 | STAFFA PLASTICA             | PLASTIC SUPPORT             | /    |                   |
| T31 | 8   | 05060001140 | SUPPORTO DRITTO-FARO        | SUPPORT FOR ROTATION LAMP   | /    |                   |
| T31 | 9   | 05060001119 | SUPPORTO " T "-FARO ROTANTE | SUPPORT -"T"- ROTATION LAMP | /    |                   |